

TYPICAL INSTALL AT INTERSECTION

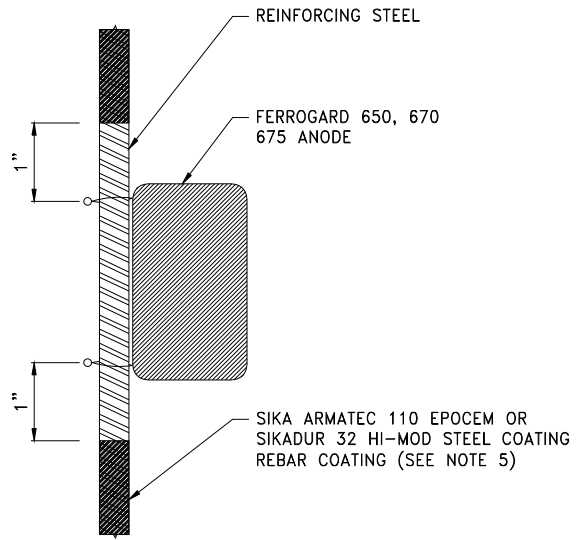

TYPICAL INSTALL BESIDE BAR

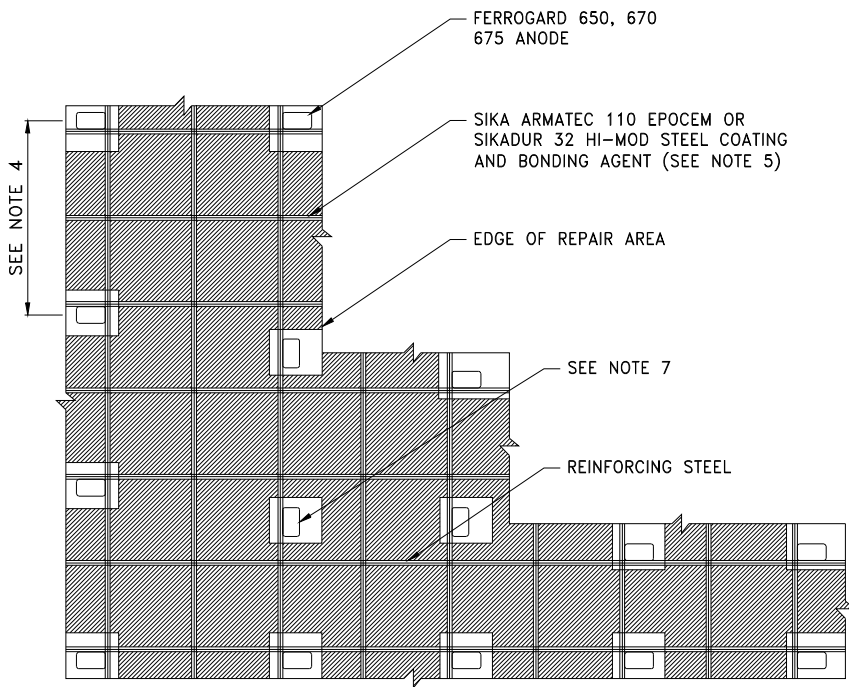

TYPICAL LAYOUT FOR SLAB REPAIR

**NOTES**

1. REMOVE DAMAGED CONCRETE USING STANDARD REPAIR METHODS
2. REPLACE / CLEAN CORRODED REINFORCING STEEL
3. ENSURE ALL EXPOSED REINFORCING STEEL IS SECURELY FASTENED TOGETHER WITH TIE WIRE TO PROVIDE GOOD CONTINUITY
4. ATTACH FERROGARD 650, 670, OR 675 ANODES TO CLEAN REINFORCING STEEL AT AN EVEN SPACING WITHIN THE PATCH AREA OR AS OUTLINED IN THE CONTRACT SPECIFICATION
5. WHEN SIKA ARMATEC 110 EPOCEM OR SIKADUR 32, HI-MOD IS USED AS A BONDING AGENT AND/OR STEEL COATING, DO NOT APPLY THE MATERIAL TO THE CONCRETE NOR STEEL WITHIN 1" OF THE TIE WIRES NOR ANODES.
6. POUR BACK REPAIR AREA WITH REPAIR MATERIAL AS PER CONTRACT SPECIFICATION
7. FERROGARD 650, 670, AND 675 ANODES ARE GENERALLY ONLY INSTALLED ALONG THE PERIMETER OF THE REPAIR AREA WHERE ALL CHLORIDE CONTAMINATED CONCRETE HAS BEEN REMOVED. FERROGARD 650, 670, AND 675 SHOULD BE PLACED ON A GRID PATTERN WITHIN THE INTERIOR OF THE REPAIR AREA WHEN CHLORIDE CONTAMINATED CONCRETE EXISTS IN CONTACT WITH THE REINFORCING STEEL



1-800-933-SIKA (7452)  
www.sikausa.com

JOB NAME:			
DETAIL TITLE <b>SIKA FERROGARD 650, 670, 675 SLAB PATCH REPAIR</b>			
SCALE: <b>N.T.S.</b>	DATE: <b>2/16</b>	FILE NO.: <b>TDS</b>	DRW. NO.: <b>SR.1.1</b>

AS A MANUFACTURER OF CONSTRUCTION PRODUCTS, SIKA CORPORATION PROVIDES GENERIC DETAILS AS A GENERAL GUIDE FOR INFORMATION PURPOSES ONLY. THESE DETAILS ARE NOT INTENDED TO REPLACE SOUND ENGINEERING AND ARCHITECTURAL PRACTICES AND SHOULD NOT BE RELIED UPON FOR THAT PURPOSE. SIKA CORPORATION ASSUMES NO LIABILITY WITH RESPECT TO THE DESIGN OF THE SYSTEM, THE ARCHITECT, CONSULTANT AND/OR ENGINEER OR DESIGN PROFESSIONAL FOR A PARTICULAR PROJECT BEARS THE SOLE RESPONSIBILITY FOR THE DESIGN OF THE SYSTEM, FOR THE PREPARATION AND APPROVAL OF THE PROJECT SPECIFICATIONS, DETAILS AND SHOP DRAWINGS, AND FOR DETERMINING THEIR SUITABILITY FOR A PARTICULAR PROJECT OR APPLICATION. WHILE SIKA PROVIDES GENERAL INSTRUCTIONS FOR THE INSTALLATION OF ITS MATERIALS, THE MEANS AND METHODS USED BY THE CONTRACTOR FOR MATERIAL STORAGE, SUBSTRATE EVALUATION, SURFACE PREPARATION, AND THE INSTALLATION OF BOTH SIKA AND NON-SIKA MATERIALS ARE THE RESPONSIBILITY OF THE CONTRACTOR. THE CONTRACTOR MUST ALWAYS READ AND FOLLOW THE WARNINGS AND INSTRUCTIONS ON SIKA PRODUCT LABELS, TECHNICAL DATA SHEETS, AND MATERIAL SAFETY DATA SHEETS AVAILABLE AT WWW.SIKAUSA.COM. SIKA CORPORATION MAKES NO WARRANTY OF ANY KIND, EITHER EXPRESS OR IMPLIED, AS TO THE CONTENT OF THIS GUIDE DETAIL. SIKA SHALL NOT BE RESPONSIBLE UNDER ANY LEGAL THEORY TO ANY THIRD PARTY FOR ANY DIRECT OR CONSEQUENTIAL DAMAGES OF ANY KIND ARISING FROM THE USE OF THIS GUIDE DETAIL. ALL PRODUCTS AND SERVICES PROVIDED BY SIKA CORPORATION ARE SUBJECT TO ITS TERMS AND CONDITIONS OF SALE AVAILABLE AT WWW.SIKAUSA.COM.