

PREMIUM HAS A NEW NAME.

P2G PREMIUM



Sikaflex® P2G Premium 3-HOUR MDAT PRIMERLESS AGR ADHESIVE

NEW AND IMPROVED FORMULATION

- Optimized performance at elevated temperatures
- Superior decking and glass-slip
- Significant reduction of odor and VOC content

PRODUCT BENEFITS

- Primerless - No pre-treatment required for glass or frit
- 3-Hour Minimum Drive-Away Time (MDAT)
- Excellent cut-off string
- Non-conductive
- Performs to FMVSS 212 requirements

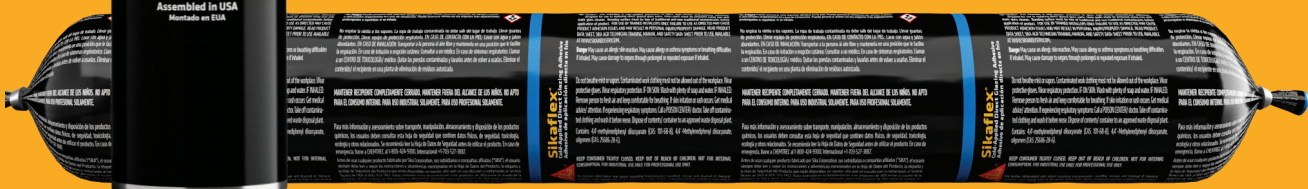

Sikaflex® P2G Premium

INNOVATION, SIMPLICITY, SAFETY...

Sikaflex® P2G Premium is a cold-applied, fast curing, high-viscosity polyurethane adhesive designed for use in replacing direct glazed automotive glass parts. Sikaflex® P2G Premium does not require the use of a Sika® Aktivator or Sika® Primer pre-treatment product on glass or ceramic frit. When used as directed Sikaflex® P2G Premium is an appropriate adhesive for use in auto glass replacement.

1



Remove the existing windshield.

2



Clean the entire pinchweld removing all dirt and debris.

3

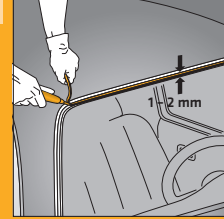

Trim back the remaining PUR bead to 1 – 2 mm. If a non-polyurethane adhesive was used previously, a complete removal is necessary!

4a



Clean the entire windshield using an Automotive grade glass cleaner.

4b



Bonding surface must be free from traditional and non-traditional contamination. Use a Sika® PowerClean Aid sponge or similar contamination removal product to ensure the glass part has been sufficiently cleaned and decontaminated.

5



Apply adhesive in a triangular shaped bead, holding the gun at a 90° angle to the surface. Properly tool the adhesive bead to avoid air gaps.

6



Set and position the glass within the open time of the adhesive. Never install a glass part after the adhesive has formed a skin. After first contact of the substrate and adhesive, do only small positioning adjustments.



Sikaflex® P2G Premium is available in the following packaging configurations:

- (10) 300 ml cartridges per carton (Sika Part#: 845157)
- (9) 600 ml unipacks per carton (Sika Part#: 862110)

Our most current General Sales Conditions shall apply.
Consult the Product Data Sheet prior to any use and processing.



SIKA CORPORATION

30800 Stephenson Highway
Madison Heights · Michigan · 48071
United States

Contact:

Phone: (800) 688-7452
sikaindustry.com/premium

BUILDING TRUST

