

# Sika Sarnafil

*World Class Roofing and Waterproofing*

## ROOFING TECHNICAL BULLETIN

**#10-13**

To: Roofing Consultants  
Authorized Roofing Applicators  
Sika Sarnafil Sales Staff & Sales Representatives  
Sika Sarnafil Regional Technical Staff  
Sika Sarnafil Customer Service Staff  
Sika Sarnafil Services Staff  
Sika Sarnafil Marketing

From: Sika Sarnafil Technical Service Department

Date: November 25, 2013

**Subject: REVISED Insulation Fastening Patterns for Adhered Systems**

---

On Sika Sarnafil's adhered membrane projects, it is important to properly attach the insulation or roof board chosen for the project with its corresponding fastening attachment specification in order to meet Sika Sarnafil, Vendor, FM and / or other technical requirements. Depending on the wind uplift values set forth in the specifications, the number of fasteners to be used and their proper spacing arrangement on the board can be found on the following pages for current insulation and roof board products Sika Sarnafil offers.



Sika Sarnafil, A Division of Sika Corporation, 100 Dan Road, Canton, MA 02021  
Tel. 800-451-2504, Fax: 781-828-5365, [www.sikacorp.com](http://www.sikacorp.com)

**Sarnafil**®

<b>Min Number of Fasteners for Adhered Applications</b>								
<b>4'x8' Product</b>	<b>Board Thickness and Corresponding FM Approved Uplift Value</b>							
<b>Polyiso</b>	<b>6</b>	<b>8</b>	<b>10</b>	<b>11</b>	<b>12</b>	<b>14</b>	<b>15</b>	<b>16</b>
Sarnatherm A	-	min 2" thick 1-90	-	1.5"-1.95" thick 1-90	-	-	-	1.3"-1.45" thick 1-90
Atlas AC II & III								
Atlas AC IV	min 2" thick 1-90	min 1" thick 1-90	-	min 2" thick 1-120	-	-	-	min 2" thick 1-135
Sarnatherm	-	min 2" thick 1-90	-	1.5"-1.95" thick 1-90	min 2" thick 1-105	-	-	-
Hunter H-Shield & CG								
Sarnatherm M	-	min 2" thick 1-90	-	-	-	-	-	min 1.5" thick 1-90
JM Enrgy3								
<b>Gypsum</b>	<b>6</b>	<b>8</b>	<b>10</b>	<b>11</b>	<b>12</b>	<b>14</b>	<b>15</b>	<b>16</b>
DensDeck	-	5/8" thick 1-90	min 1/2" thick 1-60	-	min 1/4" thick 1-60	-	-	-
DensDeck Prime	-	5/8" thick 1-90	min 1/2" thick 1-90	-	min 1/4" thick 1-90	-	-	-
Securock	-	min 1/2" thick 1-90	5/8" thick 1-105	-	min 3/8" thick 1-90*	-	min 1/4" thick 1-90**	5/8" thick 1-180
<b>High Density Coverboard</b>	<b>6</b>	<b>8</b>	<b>10</b>	<b>11</b>	<b>12</b>	<b>14</b>	<b>15</b>	<b>16</b>
Sarnatherm-A HD	-	1-60	-	-	1-75	1-90	-	-
Atlas AC-HS (1/2")								
Sarnatherm-H HD	-	-	-	-	1-75	-	-	1-90
Hunter H-Shield HD (1/2")								
Sarnatherm-M HD	-	-	-	-	-	-	-	1-90
JM Invinsa RB (1/4")								
<p>The following attachments are based on FM approved steel and concrete applications using appropriate fasteners and plates.  On any project, roof attachment components should be confirmed with owners insurance requirements. See specific fastener layouts on proceeding pages.</p> <p>* min 1/2" thick 1-120, 5/8" thick 1-135  ** min 3/8" thick 1-105, 5/8" thick 1-165</p>								

# ATLAS

## 6 FASTENERS

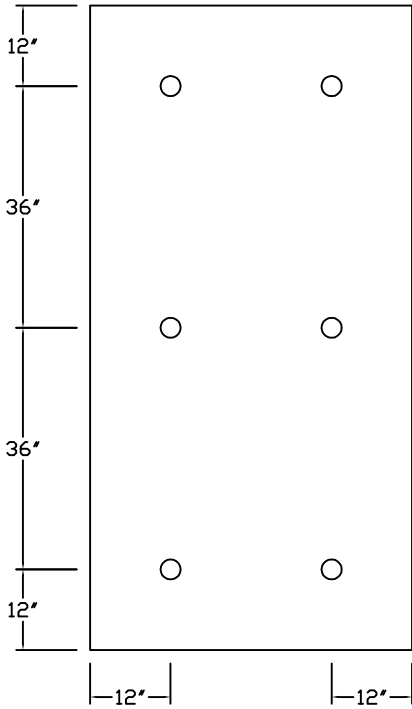

ATLAS AC IV  
MIN 2" (1-90)

## 8 FASTENERS

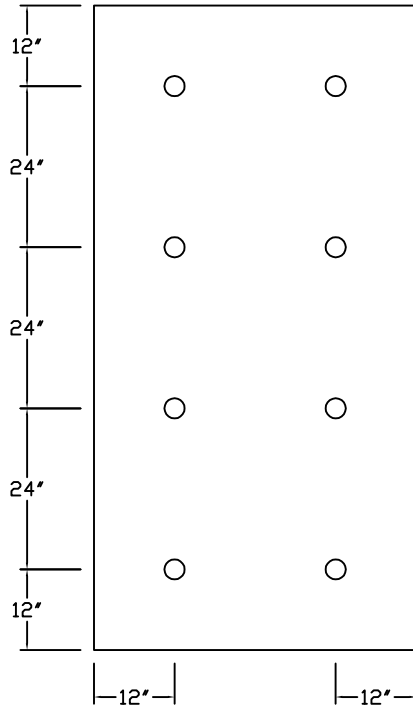

SARNATHERM A  
MIN 2" (1-90)  
ATLAS AC IV MIN 1" (1-90)  
SARNATHERM-A HD (1-60)

## 11 FASTENERS

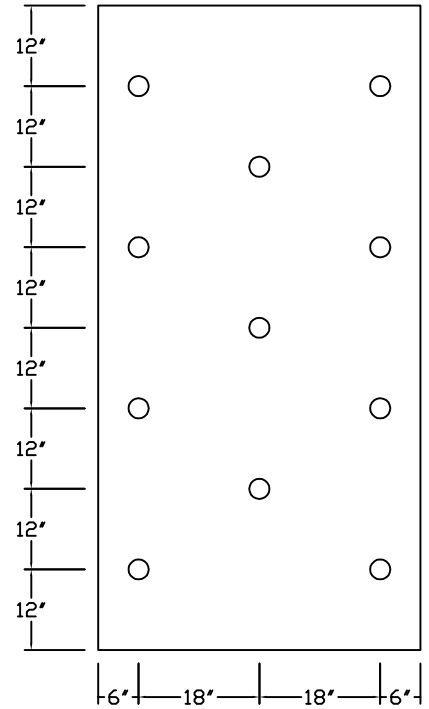

SARNATHERM A  
MIN 1.5"-1.95" (1-90)  
ATLAS AC IV  
MIN 2" (1-120)

## 12 FASTENERS

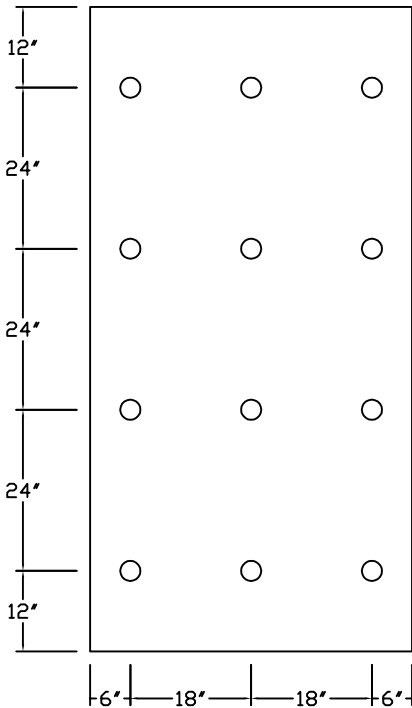

SARNATHERM-A HD  
(1-75)

## 14 FASTENERS

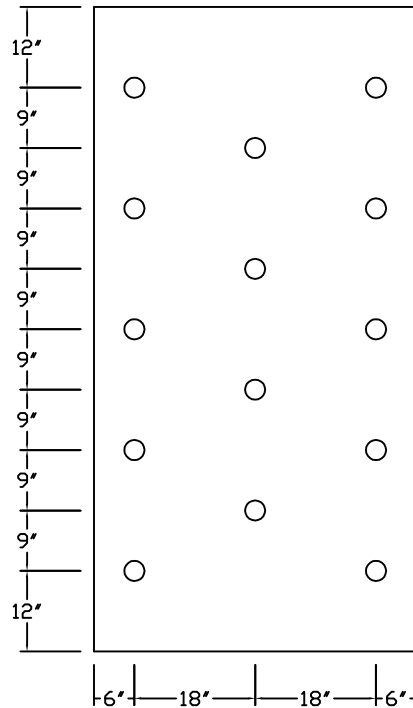

SARNATHERM-A HD  
(1-90)

## 16 FASTENERS

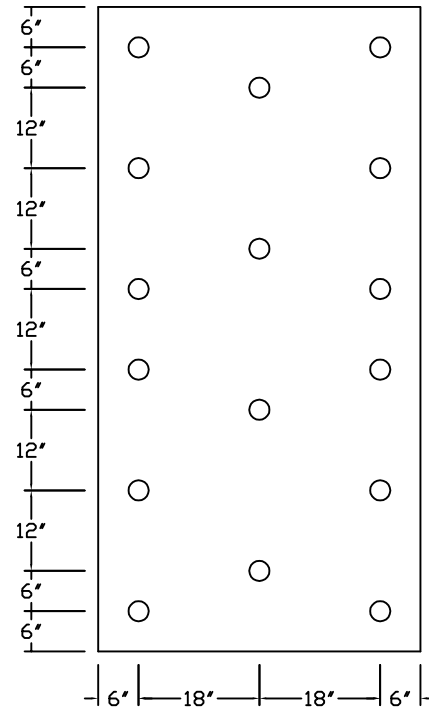

SARNATHERM A  
MIN 1.3"-1.45" (1-90)  
ATLAS AC IV  
MIN 2" (1-135)

# HUNTER

## 8 FASTENERS

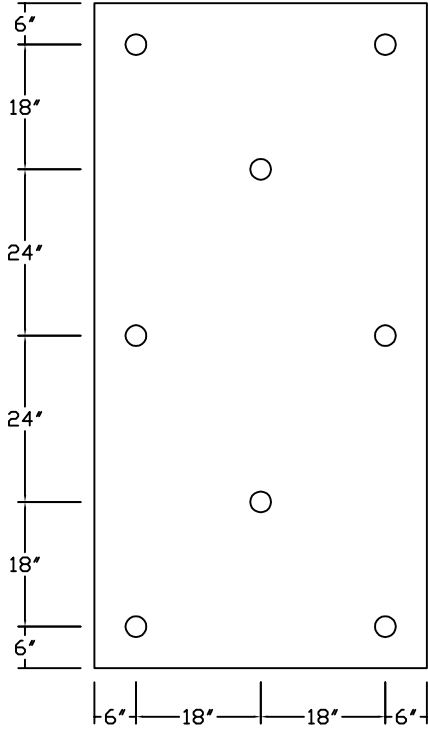

SARNATHERM  
MIN 2" (1-90)

## 11 FASTENERS

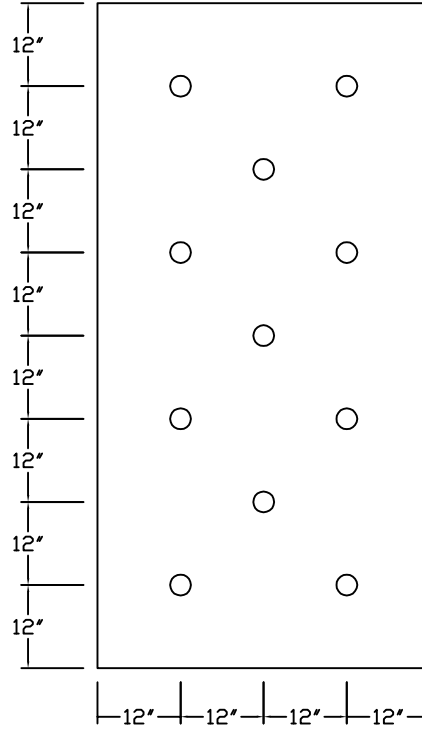

SARNATHERM  
MIN 1.5"-1.95" (1-90)

## 12 FASTENERS

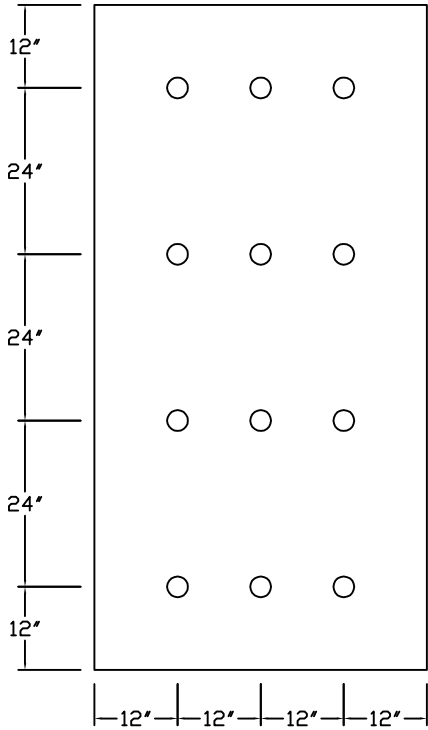

SARNATHERM  
MIN 2" (1-105)  
SARNATHERM-H HD  
(1-75)

## 16 FASTENERS

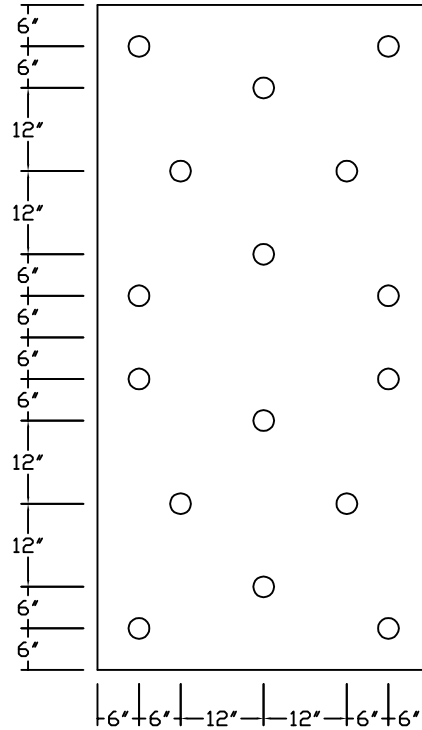

SARNATHERM-H HD  
(1-90)

# DENSDECK

## 8 FASTENERS

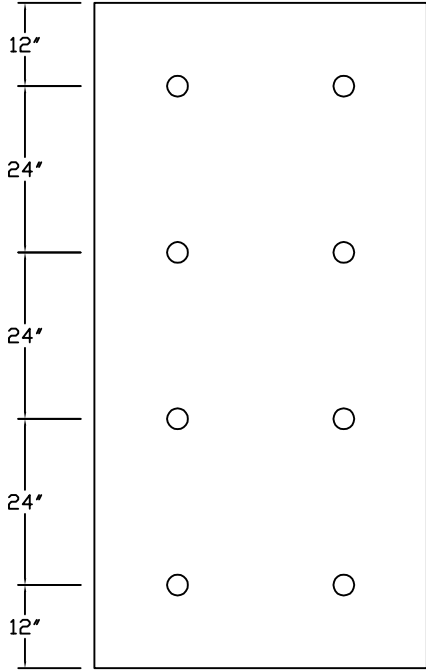

DENSDECK & PRIME  
MIN  $\frac{5}{8}$ " (1-90)

## 8 FASTENERS

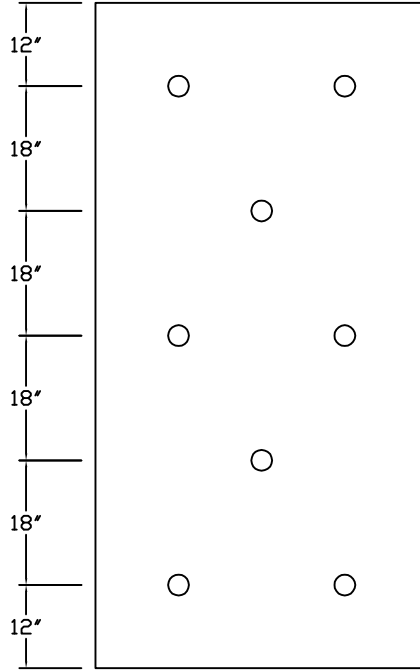

DENSDECK & PRIME  
MIN  $\frac{5}{8}$ " (1-90)  
(OPTION)

## 10 FASTENERS

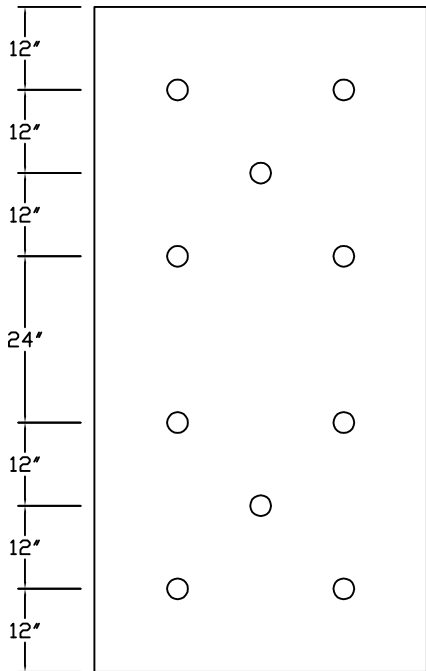

DENSDECK MIN  $\frac{1}{2}$ " (1-60)  
DENSDECK PRIME  
MIN  $\frac{1}{2}$ " (1-90)

## 12 FASTENERS

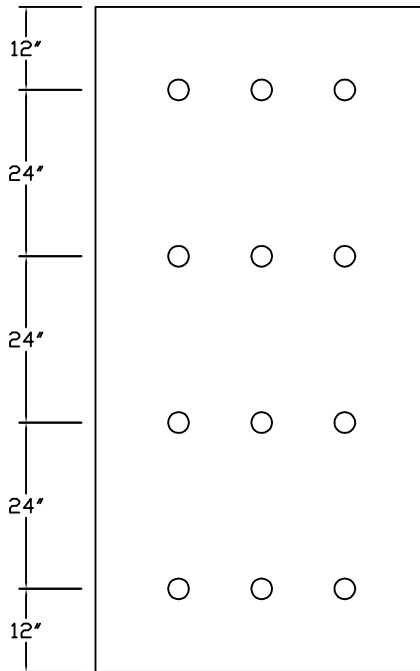

DENSDECK MIN  $\frac{1}{4}$ " (1-60)  
DENSDECK PRIME  
MIN  $\frac{1}{4}$ " (1-90)

# SECUROCK & JM

### 8 FASTENERS

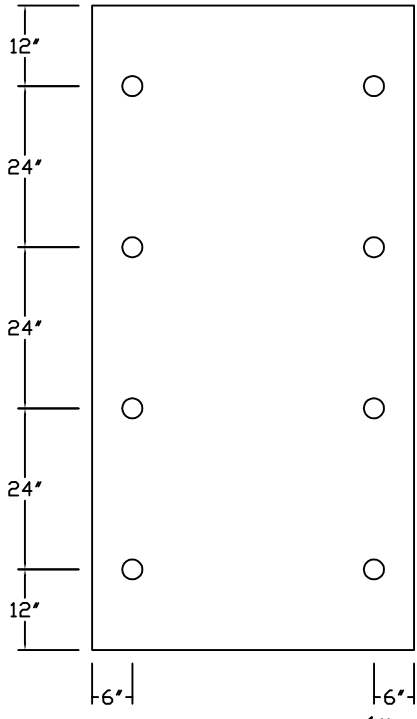

SECUROCK MIN  $\frac{1}{2}$ " (1-90)  
 SARNATHERM M MIN 2" (1-90)

### 10 FASTENERS

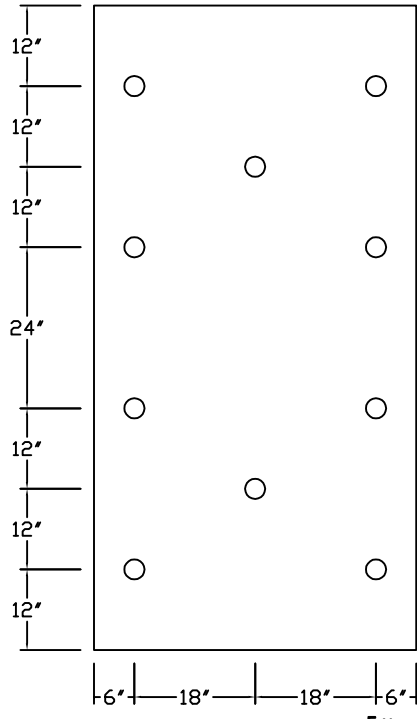

SECUROCK MIN  $\frac{5}{8}$ " (1-105)

### 12 FASTENERS

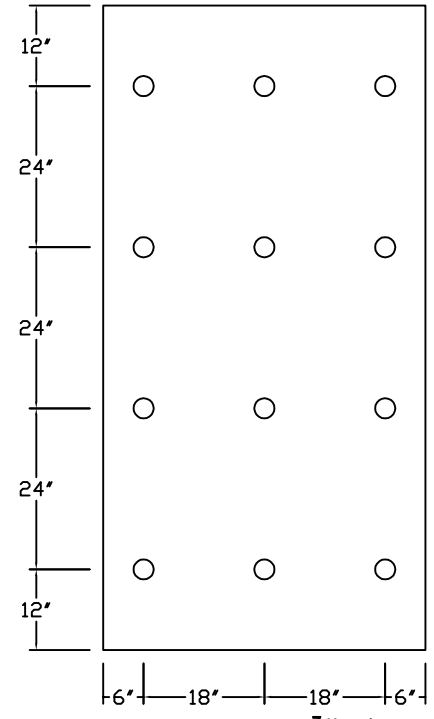

SECUROCK MIN  $\frac{3}{8}$ " (1-90)  
 SECUROCK MIN  $\frac{1}{2}$ " (1-120)  
 SECUROCK MIN  $\frac{5}{8}$ " (1-135)

### 15 FASTENERS

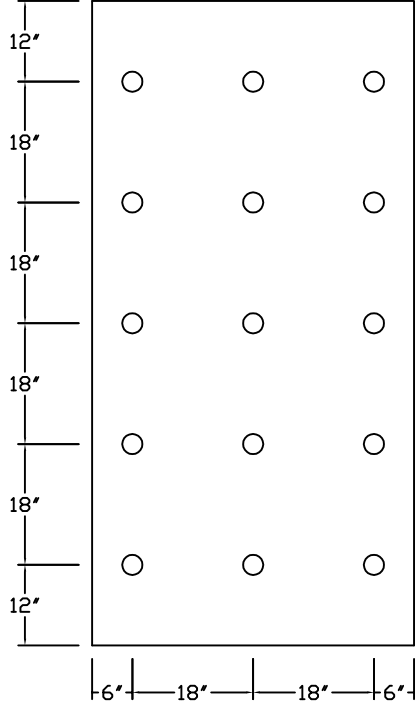

SECUROCK MIN  $\frac{1}{4}$ " (1-90)  
 SECUROCK MIN  $\frac{3}{8}$ " (1-105)  
 SECUROCK MIN  $\frac{5}{8}$ " (1-165)

### 16 FASTENERS

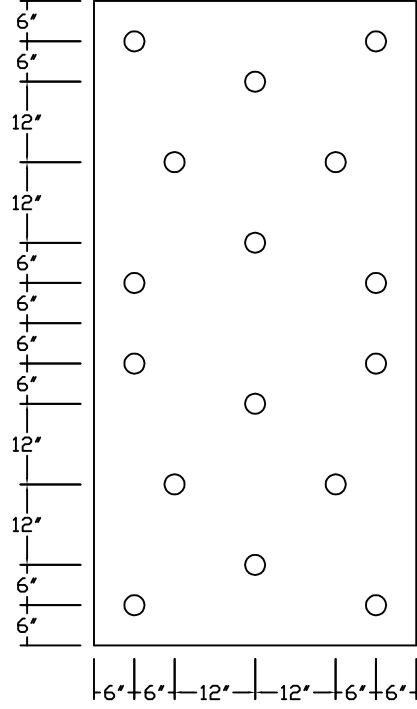

SECUROCK MIN  $\frac{5}{8}$ " (1-180)  
 SARNATHERM-M HD (1-90)

# MISC.

## 18 FASTENERS

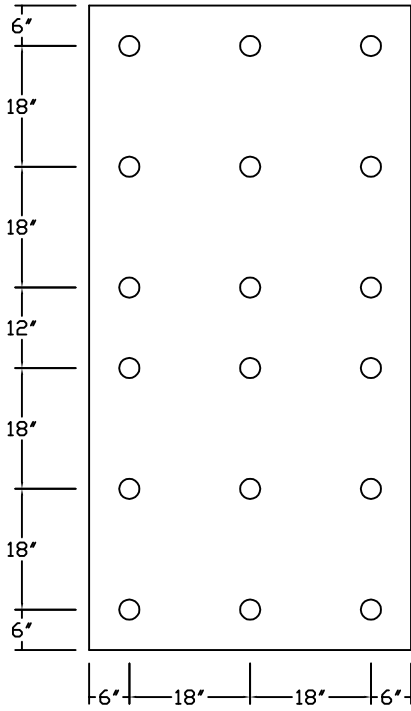

## 20 FASTENERS

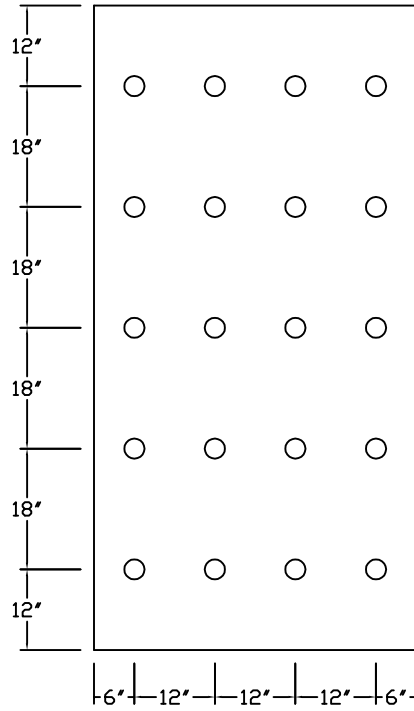

## 24 FASTENERS

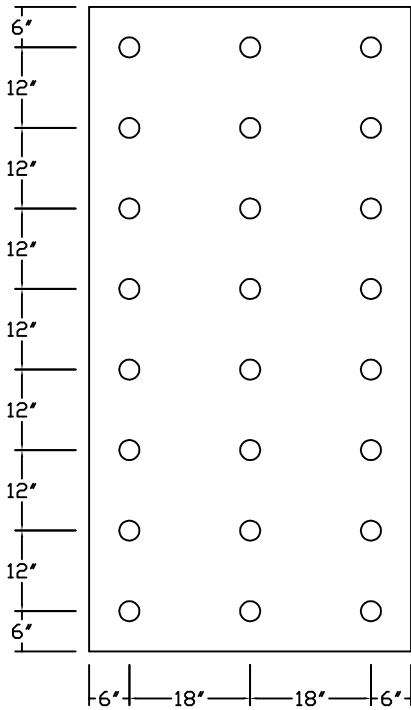

## 24 FASTENERS

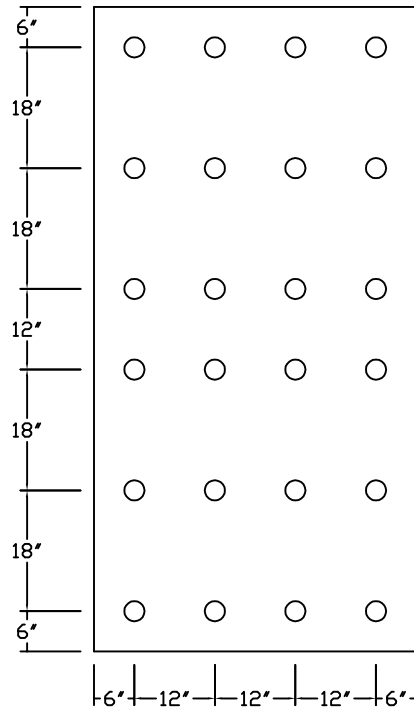

## 32 FASTENERS

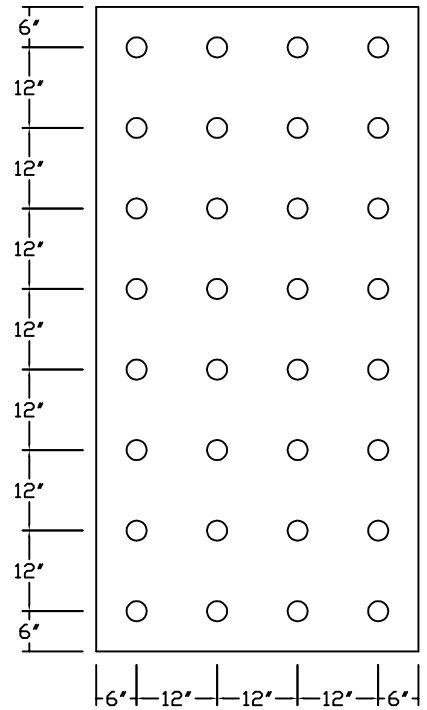

# ATLAS

6 FASTENERS

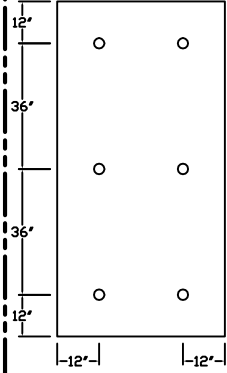

ATLAS AC IV  
MIN 2" (1-90)

8 FASTENERS

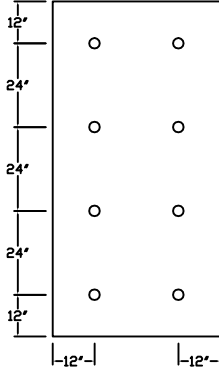

SARNATHERM A  
MIN 2" (1-90)  
ATLAS AC IV MIN 1" (1-90)  
SARNATHERM-A HD (1-60)

11 FASTENERS

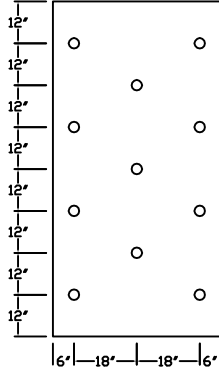

SARNATHERM A  
MIN 1.5"-1.95" (1-90)  
ATLAS AC IV  
MIN 2" (1-120)

# HUNTER

8 FASTENERS

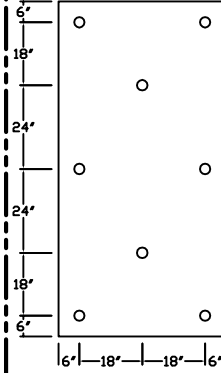

SARNATHERM  
MIN 2" (1-90)

11 FASTENERS

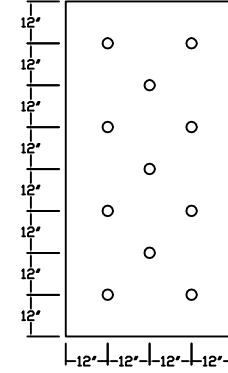

SARNATHERM  
MIN 1.5"-1.95" (1-90)

# MISC.

18 FASTENERS

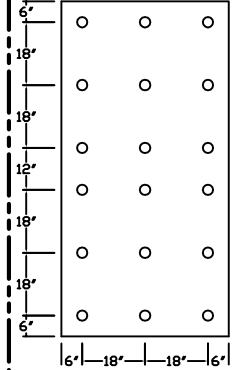

12 FASTENERS

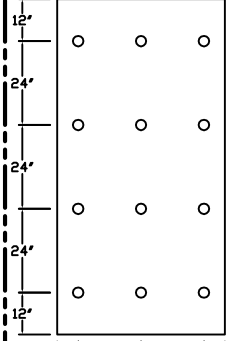

SARNATHERM-A HD  
(1-75)

14 FASTENERS

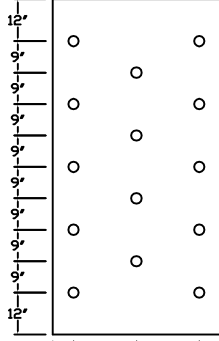

SARNATHERM-A HD  
(1-90)

16 FASTENERS

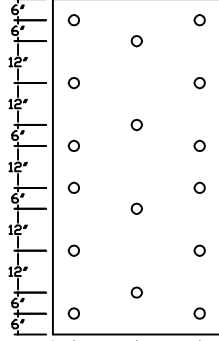

SARNATHERM A  
MIN 1.3"-1.45" (1-90)  
ATLAS AC IV  
MIN 2" (1-135)

12 FASTENERS

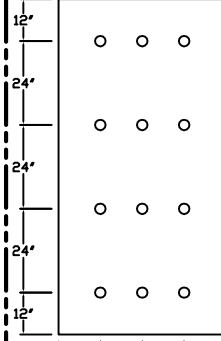

SARNATHERM  
MIN 2" (1-105)  
SARNATHERM-H HD  
(1-75)

16 FASTENERS

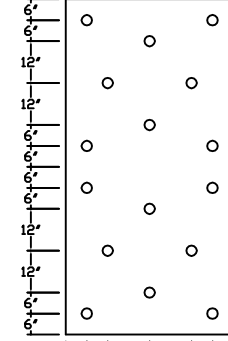

SARNATHERM-H HD  
(1-90)

20 FASTENERS

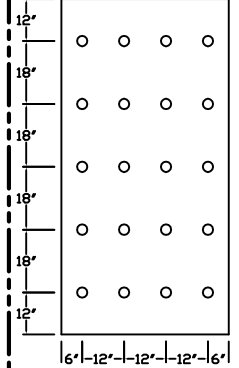

# DENSDECK

8 FASTENERS

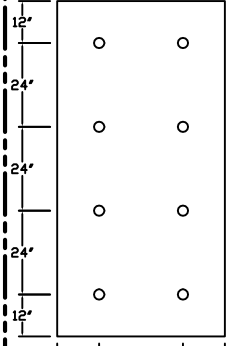

DENSDECK & PRIME  
MIN 3/8" (1-90)

8 FASTENERS

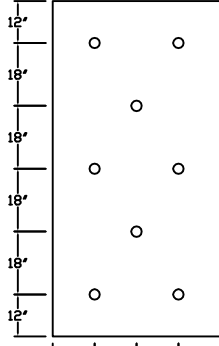

DENSDECK & PRIME  
MIN 3/8" (1-90)  
(OPTION)

8 FASTENERS

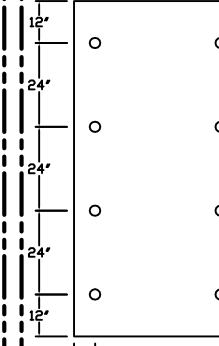

\* SARNATHERM M  
MIN 2" (1-90)  
SECUROCK MIN 1/2"  
(1-90)

# \*JM & SECUROCK

10 FASTENERS

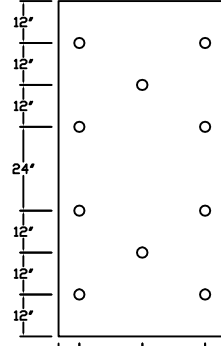

SECUROCK MIN 3/8"  
(1-105)

12 FASTENERS

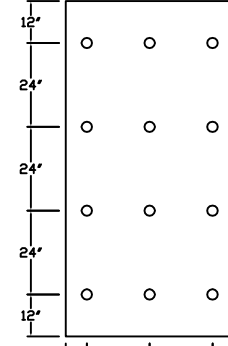

SECUROCK MIN 3/8" (1-90)  
SECUROCK MIN 1/2" (1-120)  
SECUROCK MIN 5/8" (1-135)

24 FASTENERS

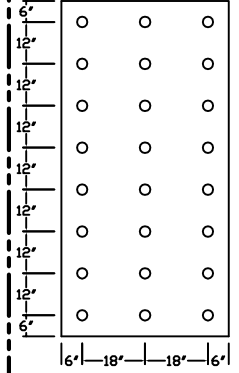

10 FASTENERS

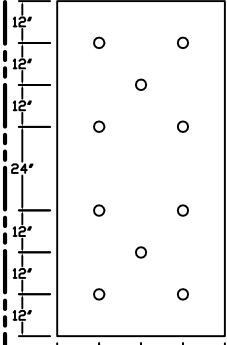

DENSDECK MIN 1/2" (1-60)  
DENSDECK PRIME  
MIN 1/2" (1-90)

12 FASTENERS

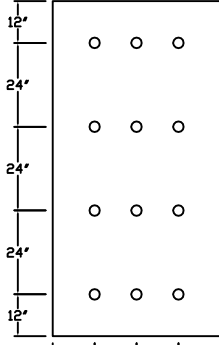

DENSDECK MIN 1/2" (1-60)  
DENSDECK PRIME  
MIN 1/2" (1-90)

15 FASTENERS

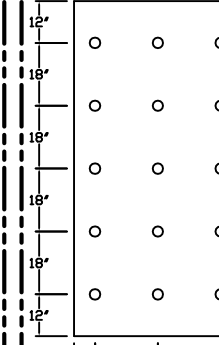

SECUROCK MIN 1/2" (1-90)  
SECUROCK MIN 3/8" (1-105)  
SECUROCK MIN 5/8" (1-165)

16 FASTENERS

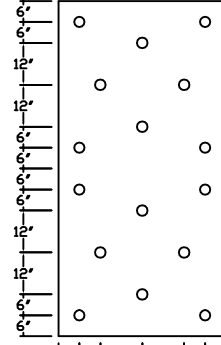

\* SARNATHERM M  
MIN 1.5" (1-90)  
\* SARNATHERM-M HD (1-90)  
SECUROCK MIN 3/8" (1-180)

32 FASTENERS

