

# reFINE EIFS Resurfacing System

A reinforced acrylic surfacing system designed for the renovation of EIFS clad buildings.

## System Description

LaHabra EIFS Resurfacing System is an acrylic surfacing system that is comprised of LaHabra base coat, reinforcing mesh and an acrylic textured finish. Applying a resurfacing system creates a refreshed aesthetic appearance, can simultaneously address multiple points of damage and allows installation of a strengthened EIFS lamina.

## Design Considerations

- Prior to resurfacing, consideration should be given to windows and other penetrations. Replacing sealant, flashing and/or inferior or damaged windows should be completed as part of a major resurfacing project.
- Perform any repairs required beyond the scope of resurfacing. Please reference Technical Bulletins *Procedure for Repairing EIFS* and *Procedure for Sealant Joint Maintenance and Repair in EIFS* for more information.
- Perform bond testing to confirm base coat adhesion. Please reference Technical Bulletin *Basics of Conducting Field Adhesion Testing* for more information. Apply SikaWall Surface Stabilizer WB to existing paint or acrylic finish as determined by adhesion testing.
- LaHabra specialty finishes can be used to create EIFS with outstanding visual appeal, revitalizing the appearance of an existing building. Brick, stone, coral, metal and specialty stucco are some of the effects that can be created when resurfacing EIFS.
- High impact reinforcing mesh is available for additional impact resistance in areas subject to heavy service conditions or to help protect against future hailstorms.
- Reference system specification for testing information.

## Uses

For exterior walls over existing retrofit EIFS claddings on commercial, institutional and residential construction such as hotels, hospitals, retail, schools, multi- family apartments and condominiums, and government facilities.

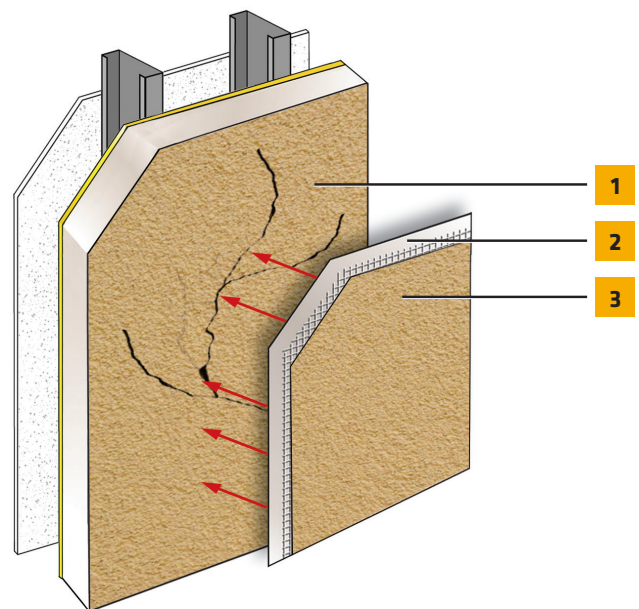

1. Existing EIFS\*
2. LaHabra Reinforcing Mesh Embedded in LaHabra Base Coat
3. LaHabra Finish

\* By Others

# reFINE EIFS Resurfacing System

## Limitations

- Use only for above grade vertical walls. Not for use below grade or on surfaces subject to continuous or intermittent immersion in water or hydrostatic pressure.
- The use of dark colors with light reflective values (LRV) less than 20% is not recommended with EIFS that incorporate expanded polystyrene (EPS). EPS has a sustained service temperature limitation of approximately 165°F (74°C).
- All products must be installed at minimum 40°F (4°C) ambient and substrate temperatures unless otherwise noted on specific Product Data Sheets. Do not apply in ambient temperatures greater than 100°F (38°C) or to surface temperature above 120°F (49°C).
- Material substitution will adversely affect system performance and will void all warranty coverage unless approved in writing by Sika Facades.
- All substrates must be clean, dry and sound. Thoroughly clean all surfaces that will be resurfaced. Please reference *Technical Bulletin Procedure for Cleaning Finish & Removing Efflorescence in EIFS and Stucco* for more information.
- Areas such as expansion joints, flashings, moisture management, sealant degradation, etc. must be inspected and addressed prior to the application of the LaHabra EIFS Resurfacing System.

## Warranty

Prior to each use of any product of Sika Corporation, its subsidiaries or affiliates ("SIKA"), the user must always read and follow the warnings and instructions on the product's most current product label, Product Data Sheet and Safety Data Sheet which are available at [usa.sika.com/lahabra](http://usa.sika.com/lahabra) or by calling SIKA Facades' Technical Service Department at 1-800-589-1336. Nothing contained in any SIKA literature or materials relieves the user of the obligation to read and follow the warnings and instructions for each SIKA product as set forth in the current product label, Product Data Sheet and Safety Data Sheet prior to use of the SIKA product.

SIKA warrants this product for one year from date of installation to be free from manufacturing defects and to meet the technical properties on the current Product Data Sheet if used as directed within the product's shelf life. User determines suitability of product for intended use and assumes all risks. User's and/or buyer's sole remedy shall be limited to the purchase price or replacement of this product exclusive of any labor costs. NO OTHER WARRANTIES EXPRESS OR IMPLIED SHALL APPLY INCLUDING ANY WARRANTY OF MERCHANTABILITY OR FITNESS FOR A PARTICULAR PURPOSE. SIKA SHALL NOT BE LIABLE UNDER ANY LEGAL THEORY FOR SPECIAL OR CONSEQUENTIAL DAMAGES. SIKA SHALL NOT BE RESPONSIBLE FOR THE USE OF THIS PRODUCT IN A MANNER TO INFRINGE ON ANY PATENT OR ANY OTHER INTELLECTUAL PROPERTY RIGHTS HELD BY OTHERS. Sale of SIKA products are subject to the Terms and Conditions of Sale which are available at [usa.sika.com](http://usa.sika.com).