

## SYSTEM DATA SHEET

# PAREX® PB

### Classic Insulated CI System

#### PRODUCT DESCRIPTION

PAREX® PB is an Exterior Insulation and Finish System (EIFS) that provides a durable weather-resistant primary barrier. The system offers design flexibility, aesthetic appeal and energy savings. Integrated system components include adhesive, EPS insulation board, reinforced base coat and 100% acrylic polymer finish. PAREX® PB complies with ASTM E 2568 and has passed rigorous tests including Full-Scale Fire, Wind-Load, Wind-Driven Rain, and Large and Small Missiles.

#### USES

For new or retrofit commercial and institutional construction such as hotels, hospitals, retail, schools, multi-family apartments and condominiums, and government facilities. PAREX® PB can be panelized to expedite year-round construction. Use over mass walls where drainage is not required.

#### CHARACTERISTICS / ADVANTAGES

- Cost-effective.
- Ability to achieve any architectural style with unlimited design options.
- Economical architectural detailing.
- Seamless exterior blanket of insulation provides high R values, lowers heating and cooling costs.
- Multiple options for impact resistance improve functional design, ease of maintenance.
- Plaster trims/accessories are not required for installation.
- Wide selection of standard colors, custom colors, and finish textures.

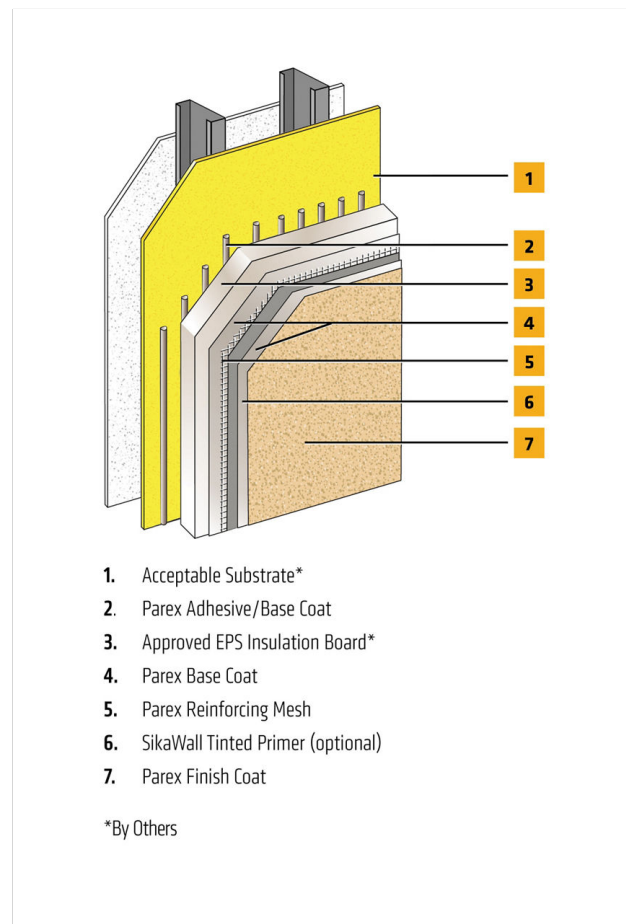

#### SYSTEM INFORMATION

System Data Sheet

PAREX® PB

June 2025, Version 01.02

021830950000242745

## APPLICATION INFORMATION

### Substrates

#### Acceptable Substrates:

Glass mat Gypsum Sheathing  
Gypsum Sheathing  
Exposure 1 OSB  
Cement Fiber Sheathing  
Concrete & Concrete Masonry  
CDX Plywood

## BASIS OF PRODUCT DATA

Results may differ based upon statistical variations depending upon mixing methods and equipment, temperature, application methods, test methods, actual site conditions and curing conditions.

## LIMITATIONS

- **Users must read the most current Product Data Sheets for each system component before using any products and follow all application instructions and cautions.**
- The design wind-load shall not exceed the system's allowable windload as stated in applicable code reports.
- System is not designed for horizontal applications.
- Use high impact mesh for ground floor applications in high traffic areas.
- Consult the framing and sheathing manufacturer for design and application considerations.
- Limit the use of dark colors. Heat build up behind dark colors can adversely affect the performance of EPS insulation. Use of colors with a light reflectance value of less than 20% require the approval of the Sika Facades Technical Department.
- Do not use below grade; system must terminate a minimum of 203 mm (8") inches above grade.
- Maximum substrate design deflection is L/240.
- Contact Sika Facades' Technical Service Department at 1-800-226-2424 for additional information.

## ENVIRONMENTAL, HEALTH AND SAFETY

For further information and advice regarding transportation, handling, storage and disposal of chemical products, user should refer to the actual Safety Data Sheets containing physical, environmental, toxicological and other safety related data. User must read the current actual Safety Data Sheets before using any products. In case of an emergency, call CHEMTREC at 1-800-424-9300, International 703-527-3887.

Fax: +1-201-933-6225

## LEGAL DISCLAIMER

- **KEEP CONTAINER TIGHTLY CLOSED**



System Data Sheet

PAREX® PB

June 2025, Version 01.02

021830950000242745

- **KEEP OUT OF REACH OF CHILDREN**
- **NOT FOR INTERNAL CONSUMPTION**
- **FOR INDUSTRIAL USE ONLY**
- **FOR PROFESSIONAL USE ONLY**

Prior to each use of any product of Sika Corporation, its subsidiaries or affiliates ("SIKA"), the user must always read and follow the warnings and instructions on the product's most current product label, Product Data Sheet and Safety Data Sheet which are available at [usa.sika.com](http://usa.sika.com) or by calling SIKA's Technical Service Department at 1-800-933-7452. Nothing contained in any SIKA literature or materials relieves the user of the obligation to read and follow the warnings and instructions for each SIKA product as set forth in the current product label, Product Data Sheet and Safety Data Sheet prior to use of the SIKA product.

SIKA warrants this product for one year from date of installation to be free from manufacturing defects and to meet the technical properties on the current Product Data Sheet if used as directed within the product's shelf life. User determines suitability of product for intended use and assumes all risks. User's and/or buyer's sole remedy shall be limited to the purchase price or replacement of this product exclusive of any labor costs. **NO OTHER WARRANTIES EXPRESS OR IMPLIED SHALL APPLY INCLUDING ANY WARRANTY OF MERCHANTABILITY OR FITNESS FOR A PARTICULAR PURPOSE. SIKA SHALL NOT BE LIABLE UNDER ANY LEGAL THEORY FOR SPECIAL OR CONSEQUENTIAL DAMAGES. SIKA SHALL NOT BE RESPONSIBLE FOR THE USE OF THIS PRODUCT IN A MANNER TO INFRINGE ON ANY PATENT OR ANY OTHER INTELLECTUAL PROPERTY RIGHTS HELD BY OTHERS.**

Sale of SIKA products are subject to the Terms and Conditions of Sale which are available at <https://usa.sika.com/en/group/SikaCorp/termsandconditions.html> or by calling 1-800-933-7452.

PAREXPB-en-US-(06-2025)-1-2.pdf

