

Adhered Veneer Surfacing for Concrete and Masonry Units

SYSTEM DESCRIPTION

Adhered Veneer Surfacing System for Concrete and Masonry Units is a weather resistant surfacing system incorporating LaHabra Finestop fluid applied air/awater-resistive barrier and SikaWall MaxGrip Veneer Adhesive - a specially formulated high-strength setting bed mortar used to adhere natural and manufactured stone, tile, and thin brick veneer.

USES

For exterior walls in new or retrofit commercial, institutional and residential construction such as hotels, hospitals, retail, schools, multi-family apartments and condominiums, and government facilities.

ACCEPTABLE SUBSTRATES

Concrete Masonry Units (excluding fluted block; split faced block should be assessed on project by project basis), brick and concrete walls.

DESIGN CONSIDERATIONS

- Use only for above grade vertical walls. Not for use below grade or on surfaces subject to continuous or intermittent immersion in water or hydrostatic pressure.
- Per code veneer unit shall not exceed 2 5/8" (66.7 mm) in specified thickness, 36" (914 mm) in longest dimension not more than 5 ft² (0.46 m²) in total face area and shall not weigh more than 15 lbs/ft² (718 Pa).
- All products must be installed at minimum 40°F (4°C) ambient and substrate temperatures unless otherwise noted on specific Product Data Sheets.
- All products must be stored in accordance with specific instructions on relevant Product Data Sheets.
- All substrates must be clean, dry and sound without planar irregularities greater than 1/4" per 10' (6 mm per 3 m).
- Painted and otherwise coated surfaces should be inspected and prepared as approved by Sika Facades before application.
- Ensure substrate is free of all form releasing agents or other residue. The applicator shall verify that the proposed substrate is acceptable prior to the LaHabra Adhered Veneer Surfacing System installation.
- Reference system specification for testing information.
- When used on retention wall or areas where moisture may accumulate or enter the opposite side of the wall, a waterproofing material is required on the opposite side of the wall to eliminate negative hydrostatic pressure.
- Ensure tops of walls are capped or otherwise properly protected.
- Locate joints in adhered veneer above joints in CMU or concrete substrates and where indicated by design professional.

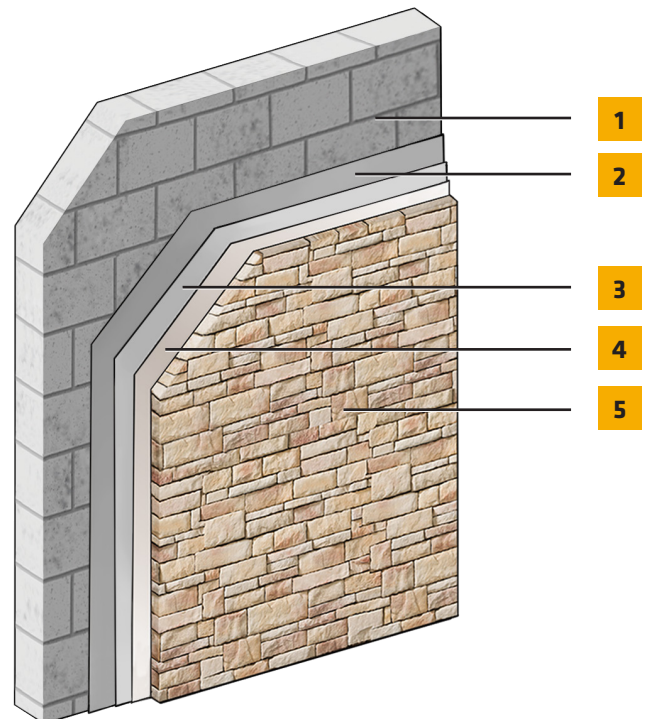

1. Acceptable Substrates*
2. Finestop RA/RS/VB with optional SikaWall Block Filler
3. Skim Coat of SikaWall MaxGrip Veneer Adhesive
4. SikaWall MaxGrip Veneer Adhesive
5. Adhered Veneer*

*By Others

Adhered Veneer Surfacing for Concrete and Masonry Units

MATERIAL SUBSTITUTION

Material substitution will adversely affect system performance and will void all warranty coverage unless approved in writing by Sika Facades.

WARRANTY

Prior to each use of any product of Sika Corporation, its subsidiaries or affiliates ("SIKA"), the user must always read and follow the warnings and instructions on the product's most current product label, Product Data Sheet and Safety Data Sheet which are available at usa.sika.com/lahabra or by calling SIKAFACADES' Technical Service Department at 1-800-589-1336. Nothing contained in any SIKAFACADES literature or materials relieves the user of the obligation to read and follow the warnings and instructions for each SIKAFACADES product as set forth in the current product label, Product Data Sheet and Safety Data Sheet prior to use of the SIKAFACADES product.

SIKAFACADES warrants this product for one year from date of installation to be free from manufacturing defects and to meet the technical properties on the current Product Data Sheet if used as directed within the product's shelf life. User determines suitability of product for intended use and assumes all risks. User's and/or buyer's sole remedy shall be limited to the purchase price or replacement of this product exclusive of any labor costs. NO OTHER WARRANTIES EXPRESS OR IMPLIED SHALL APPLY INCLUDING ANY WARRANTY OF MERCHANTABILITY OR FITNESS FOR A PARTICULAR PURPOSE. SIKAFACADES SHALL NOT BE LIABLE UNDER ANY LEGAL THEORY FOR SPECIAL OR CONSEQUENTIAL DAMAGES. SIKAFACADES SHALL NOT BE RESPONSIBLE FOR THE USE OF THIS PRODUCT IN A MANNER TO INFRINGE ON ANY PATENT OR ANY OTHER INTELLECTUAL PROPERTY RIGHTS HELD BY OTHERS. Sale of SIKAFACADES products are subject to the Terms and Conditions of Sale which are available at usa.sika.com.

Sika Corporation

201 Polito Avenue
Lyndhurst, NJ 07071 USA
Customer Service +1 (800) 433-9517
Technical Service +1 (800) 589-1336
usa.sika.com/lahabra

Rev April 2024

BUILDING TRUST

