

***Senergy***<sup>®</sup>



# CHANNELED ADHESIVE CI DESIGN

A SYSTEMS APPROACH TO THE BUILDING ENCLOSURE

**BUILDING TRUST**



# SENERGY CHANNELED ADHESIVE CI DESIGN

---

**There is a lot to consider when designing and constructing a modern building enclosure. From energy efficiency and fire performance to evolving building codes, durability, aesthetic appeal, budget and so much more.**

You can piecemeal it together – choose the components separately from different manufacturers, then assemble them in a way that meets all the project and building code requirements. Or you can turn to Senergy, a Sika brand, for the Channeled Adhesive CI Design, a fully integrated, code compliant wall system with unlimited aesthetic options and covered under a single source manufacturer warranty. More than a set of products, the insulated cladding system has been tested, detailed and supported to meet the needs and requirement of modern building design and construction.







# BUILD WITH CONFIDENCE

---

**RIGOROUSLY TESTED AND EVALUATED** to ensure components work together as a fully integrated, code-compliant system, the Channeled Adhesive CI Design wall system is listed by ICC Evaluation Service in ESR-1878 evaluation report.



## **ENERGY EFFICIENCY**

By including insulation outside of the framing, thermal expansion and contraction of the framing is reduced. Adhesively attached continuous exterior layer of insulation provides long term energy efficiency savings. Since lintels and mechanical fasteners are not needed, thermal bridges are practically eliminated. Channeled Adhesive CI Design uses at least one-inch and as much as 12-inches of Type I expanded polystyrene (EPS) insulation board with an R-Value of 3.85/inch (Type I at 75°F). Designers can easily specify the right level of continuous insulation, based on the project's climate zone, wall design, and occupancy.

## **MOISTURE PROTECTION**

Senergy Channeled Adhesive CI Design handles air and water with Senershield fluid-applied air/water-resistive barrier. Per ASTM E2273, the system provides 98.7% drainage efficiency. Other aspects of air/water-resistive barrier code compliance are confirmed by performance testing according to ICC-ES Acceptance Criteria AC 212. The system also incorporates an adhesive drainage plane, allowing moisture to escape, reducing the risk of mold and costly moisture damage.

## **DURABILITY**

The exterior skin of Channeled Adhesive CI Design uses fiberglass reinforcement embedded in Senergy polymer modified cement base coat. Senergy base coat provides water-resistance, resilience, and noncombustibility. Senergy offers a wide range of reinforcing mesh products to meet the required strength and durability. Channeled Adhesive CI Design holds several Miami-Dade County Notices of Acceptance (NOAs). You can specify the required strength wherever it is needed.

## **FIRE PERFORMANCE**

Fire is a complex thing that is not easily tested. The most rigorous fire tests are performed on wall assemblies, not materials. Channeled Adhesive CI Design has demonstrated compliance with NFPA 285 and 268 and does not affect the performance of a fire-rated wall assembly, tested per ASTM E119.

## **SINGLE-SOURCE WARRANTY**

Senergy, a brand of Sika stands behind the Channeled Adhesive CI Design wall system, with a Limited Labor, Material, and Drainage Warranty. Coverage extends to sheathing and framing in addition to Channeled Adhesive CI Design itself.



# THE ULTIMATE SOLUTION

**CHANNELED ADHESIVE CI DESIGN** is a continuously insulated moisture drainage wall cladding system. The fully integrated system features a Senersshield fluid-applied air/water-resistive barrier, moisture drainage, up to R46 (12" Type I EPS) continuous exterior insulation, optional SikaWall Ultra HI 20 reinforcing mesh and a wide range of finish options.

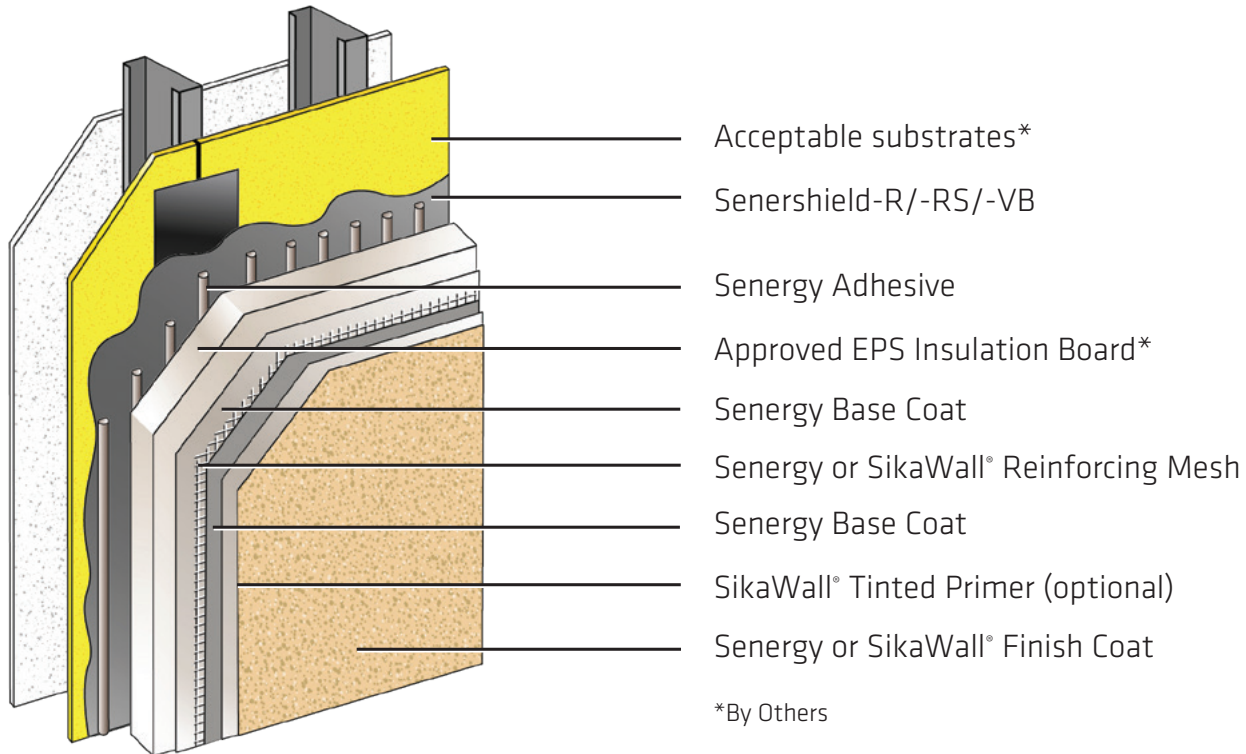

CODE COMPLIANCE	
Document	Code Description
ICC-ESR 1878	Complies with IBC and IRC
ASTM E2568 / AC 235	Complies with requirements
ASTN E119	Does not detract from fire rating of base wall
ICC-ESR 2986 (Senersshield-R/-RS)	Air/water-resistive barrier†
NFPA 285/268	Meets requirements for use on fire-resistance-rated construction and in any construction type, including IBC Types I through V
CCMC 13062-R	Complies with National Building Code of Canada
Miami Dade NOAs	Meets Miami Dade hurricane requirements.
For testing results, please reference Senerflex Channeled Adhesive CI Design Specification.	

**Acceptable Substrates:** PermaBase® Cement Board and other cement boards conforming with ASTM C1325 (Type A - exterior); poured concrete/unit masonry; ASTM C1177 type sheathings, including Weather Defense™ Platinum sheathing, GreenGlass® sheathing, eXP™ sheathing, GlasRoc® sheathing, Securock™ glass-mat sheathing, and DensGlass® exterior sheathing; DensElement (sheathing only), gypsum sheathing (ASTM C79/C1396); Exposure I or exterior plywood (Grade C/D or better); or Exposure I OSB; Huber Zip (sheathing only).

† Senersshield-R/-RS/-VB can be used behind all claddings where more than one wall system is specified, creating one continuous AWRB system. This is appropriate whenever Senergy Channeled Adhesive CI Design is used with other cladding types on a multi-clad building.

# AESTHETIC VERSATILITY

Multi-cladding appearances are visually interesting but can be complicated to achieve. A continuous layer of insulation and air/water-resistive barrier must be monolithic and unbroken, with a defined drainage plane. Meticulous labor coordination and handoff is critical where multiple claddings require multiple installation teams.

With Channeled Adhesive CI Design, multi-cladding design can be easily achieved over a continuous layer of insulation, air/water-resistive barrier and drainage with one installation crew. From wood grain and metallic panels to stucco, granite and so much more. Choose from an unlimited selection of colors and textures to achieve the required look and feel.



## SENERGY FINISHES

ACHIEVE THE LOOK AND FEEL YOU WANT

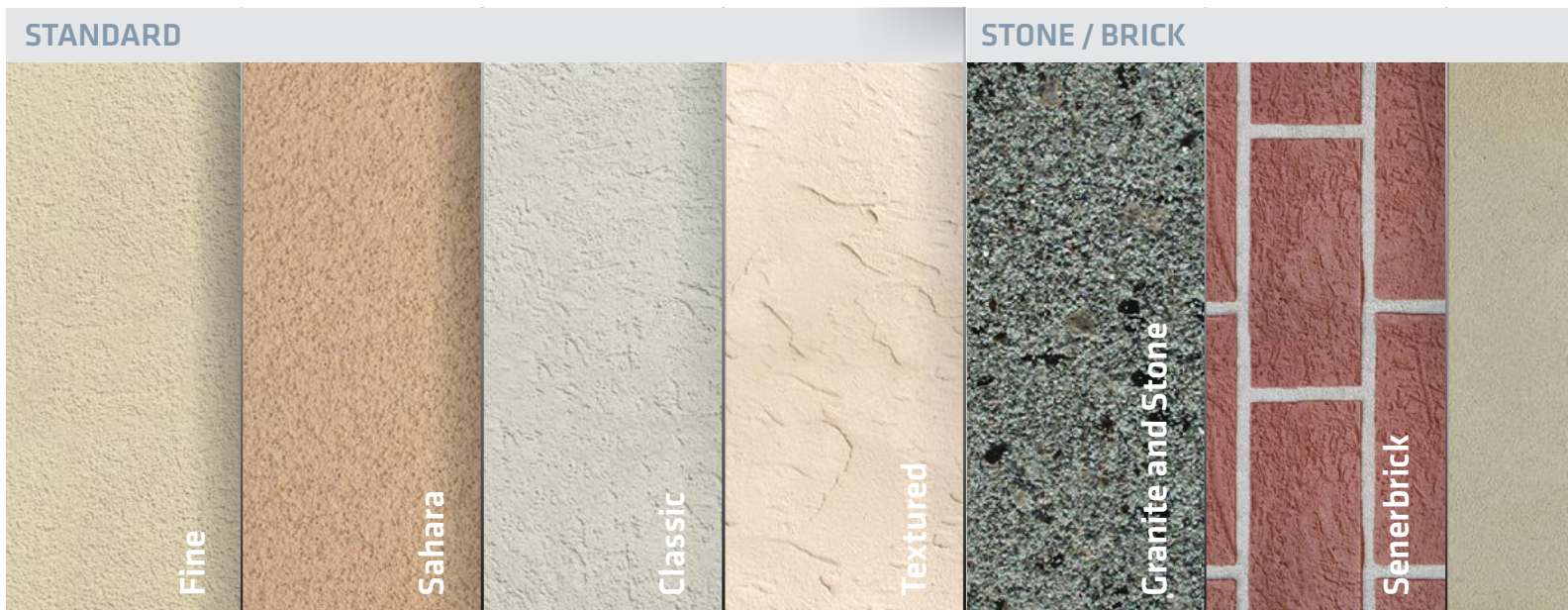





SPECIALTY

Limestone Rendering

Intonaco

Metallic

Chroma

Wood Grain

Encausto Verona

Tersus





VIEW  
MORE  
PROJECTS



Our most current General Sales Conditions shall apply.  
Please consult the Data Sheet prior to any use and processing

© 2024 Sika Corporation, 45219857 rev 07/2024

**Sika Corporation**  
201 Polito Avenue  
Lyndhurst, NJ 07071 USA  
Customer Service (800) 433-9517  
Technical Service (800) 243-6739  
[usa.sika.com/senergy](http://usa.sika.com/senergy)

**BUILDING TRUST**

