

PRODUCT DATA SHEET

Sika® Anchor-300

anchor fixation through sheet waterproofing membranes

PRODUCT DESCRIPTION

Sika® Anchor-300 is a hard PVC anchor shaft in grey colour combined with Sikaplan® PVC waterproofing membrane flange in yellow colour.

USES

Sika® Anchor-300 is used in double-shell tunnel constructions in combination with waterproofing sheet membranes on base of PVC-p to temporary fix the reinforcement of the inner lining to the outer shell, until the secondary concrete or shotcrete lining is cured and self-supporting.

PRODUCT INFORMATION

Packaging	30 pcs per box
Appearance / Color	PVC Membrane PVC Shaft

yellow and black
grey

CHARACTERISTICS / ADVANTAGES

- Allows watertight hot air welded seam with Sikaplan® WP membranes
- Good force transfer through hard PVC shaft
- Waterproofing line around anchor (no additional sealing elements required)
- Anchor steel corrosion-protected
- Quick and simple installation

APPROVALS / STANDARDS

Watertightness test (Vacuum testing):
-0.2 MPa by Sika Testing System TM 87

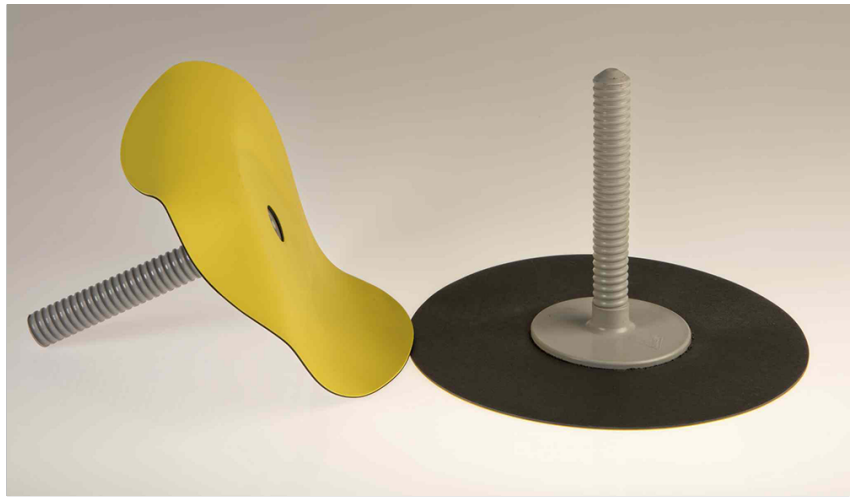

Shelf Life

5 years shelf life from date of production if stored properly in undamaged, unopened, original sealed packaging

Storage Conditions

Store in dry conditions, protected from direct sunlight, rain, snow and ice, etc.

Dimensions

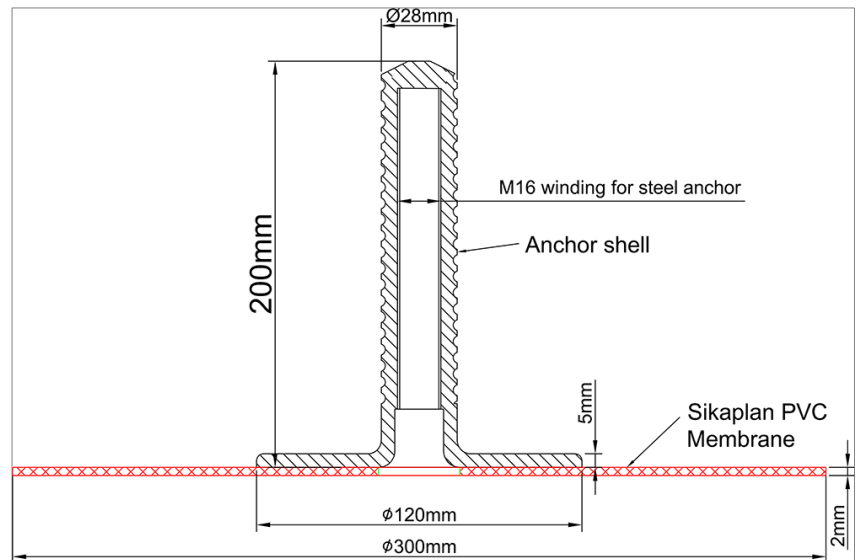

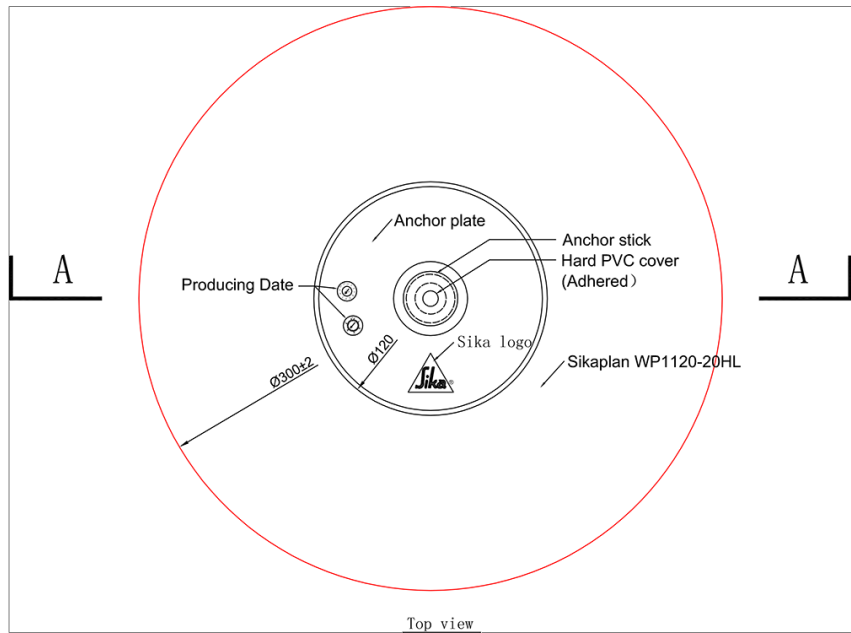

Diameter Shaft: Inside Thread M16, length 200 mm
Membrane: 300 mm

Thickness Membrane: 2.0 mm

TECHNICAL INFORMATION

Ambient Maximum Temperature of Liquids + 95 °F max

SYSTEM INFORMATION

System Structure

Ancillary products:

- Sikaplan® WP 1100 -types
- Sikaplan® WP 1110 -types
- Sikaplan® WP 1120 -types
- Sikaplan® WP 2101 -types
- Sikaplan® WP 2110 -types
- Sikaplan® WP Protection Sheet-Types
- Sikadur® -31
- Sika Greenstreak® Epoxy 7300
- Sika® AnchorFix®-2

APPLICATION INFORMATION

Ambient Air Temperature Min. +40 °F

APPLICATION INSTRUCTIONS

SUBSTRATE QUALITY

The substrate conditions are as defined for the waterproofing membrane system which is to be combined with the Sika® Anchor-300.

APPLICATION METHOD / TOOLS

Installation method:

1. Cut out a small section of the waterproofing system or drill through it directly
2. Drill a hole into the substrate
3. Clean the drill hole with high pressure water jet
4. Clean the drill hole with compressed air
5. Inject Sikadur® -31, Sika Greenstreak® Epoxy 7300 or Sika® AnchorFix®-2, or use anchor capsule
6. Install Sika® Anchor-300
7. Weld against Sikaplan® PVC membrane
8. Install steel anchor for temporary fixing of rebar cage

LIMITATIONS

- Sika® is not responsible for the permissible anchor forces or the related loading calculations.
- Preliminary pull-out tests are mandatory.
- Installation works must only be carried out by Sika® trained contractors.
- The membrane is not UV stabilized and cannot be installed on structures permanently exposed to sunlight and weathering.

BASIS OF PRODUCT DATA

Results may differ based upon statistical variations depending upon mixing methods and equipment, temperature, application methods, test methods, actual site conditions and curing conditions.

OTHER RESTRICTIONS

See Legal Disclaimer.

ENVIRONMENTAL, HEALTH AND SAFETY

REGULATION (EC) NO 1907/2006 - REACH

This product is an article as defined in article 3 of regulation (EC) No 1907/2006 (REACH). It contains no substances which are intended to be released from the article under normal or reasonably foreseeable conditions of use. A safety data sheet following article 31 of the same regulation is not needed to bring the product to the market, to transport or to use it. For safe use follow the instructions given in the product data sheet. Based on our current knowledge, this product does not contain SVHC (substances of very high concern) as listed in Annex XIV of the REACH regulation or on the candidate list published by the European Chemicals Agency in concentrations above 0,1 % (w/w).

LEGAL DISCLAIMER

- KEEP CONTAINER TIGHTLY CLOSED
- KEEP OUT OF REACH OF CHILDREN
- NOT FOR INTERNAL CONSUMPTION
- FOR INDUSTRIAL USE ONLY
- FOR PROFESSIONAL USE ONLY

Prior to each use of any product of Sika Corporation, its subsidiaries or affiliates ("SIKA"), the user must always read and follow the warnings and instructions on the product's most current product label, Product Data Sheet and Safety Data Sheet which are available at usa.sika.com or by calling SIKA's Technical Service Department at 1-800-933-7452. Nothing contained in any SIKA literature or materials relieves the user of the obligation to read and follow the warnings and instructions for each SIKA product as set forth in the current product label, Product Data Sheet and Safety Data Sheet prior to use of the SIKA product.

SIKA warrants this product for one year from date of installation to be free from manufacturing defects and to meet the technical properties on the current Product Data Sheet if used as directed within the product's shelf life. User determines suitability of product for intended use and assumes all risks. User's and/or buyer's sole remedy shall be limited to the purchase price or replacement of this product exclusive of any labor costs. **NO OTHER WARRANTIES EXPRESS OR IMPLIED SHALL APPLY INCLUDING ANY WARRANTY OF MERCHANTABILITY OR FITNESS FOR A PARTICULAR**

PURPOSE. SIKA SHALL NOT BE LIABLE UNDER ANY LEGAL THEORY FOR SPECIAL OR CONSEQUENTIAL DAMAGES. SIKA SHALL NOT BE RESPONSIBLE FOR THE USE OF THIS PRODUCT IN A MANNER TO INFRINGE ON ANY PATENT OR ANY OTHER INTELLECTUAL PROPERTY RIGHTS HELD BY OTHERS.

Sale of SIKA products are subject to the Terms and Conditions of Sale which are available at <https://usa.sika.com/en/group/SikaCorp/termsandconditions.html> or by calling 1-800-933-7452.

Sika Corporation

201 Polito Avenue
Lyndhurst, NJ 07071
Phone: +1-800-933-7452
Fax: +1-201-933-6225
usa.sika.com

Sika Mexicana S.A. de C.V.

Carretera Libre Celaya Km. 8.5
Fracc. Industrial Balvanera
Corregidora, Queretaro
C.P. 76920
Phone: 52 442 2385800
Fax: 52 442 2250537



Product Data Sheet

Sika® Anchor-300
August 2020, Version 01.01
02072080200000014

SikaAnchor-300-en-US-(08-2020)-1-1.pdf

