

# Form and Step Liners

LITHOTEX® Pavecrafters® Concrete Patterns and Textures

- 4" Cantilevered Cut Stone Step Liner

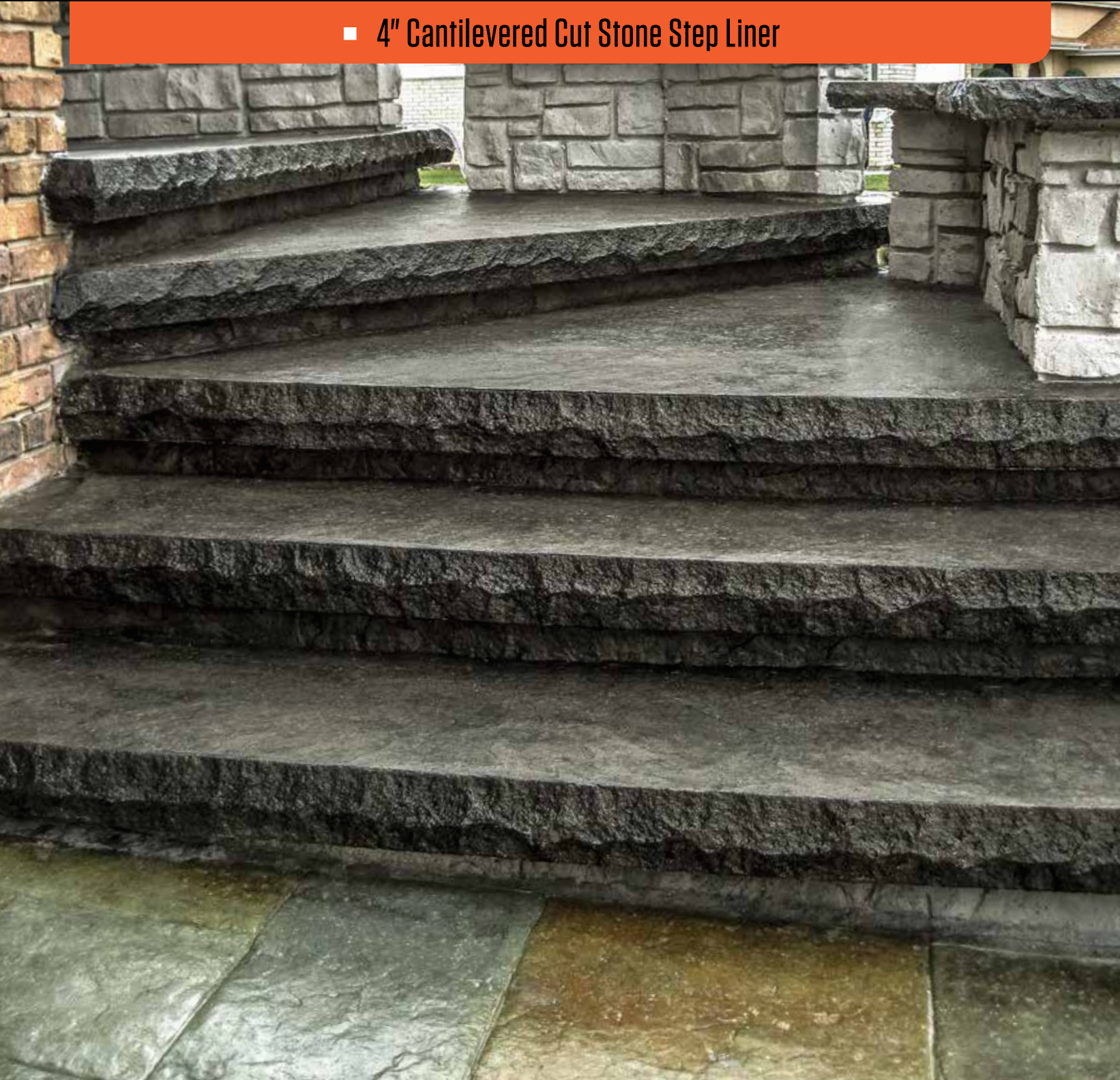



# STACKABLE FORM LINER



## 6" Stackable Cobblestone Form Liner

### Available Tools:

- 6" Liner A – S50068A (see **A**)
- 6" Liner B – S50068B (see **B**)

### Additional Tools:

- Control Joint Texture Strip – S58001
- 2' Offset – S50062
- 8" End Set of 2 – S5006E08
- 10" End Set of 2 – S5006E10

The 6" Stackable Cobblestone Form Liner minimizes stone repetition by alternating Liner A, Liner B, and the 2' Offset during stacking.

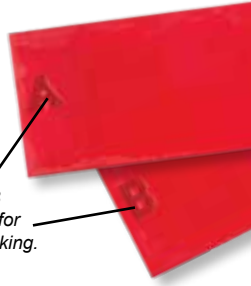

Both Liner A and Liner B are labeled on the back for identification during stacking.

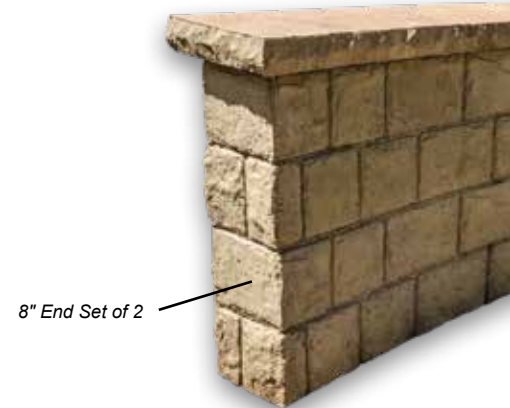

8" End Set of 2

Grout Line Width: 3/16"-3/8"  
Grout Line Depth: 1/16"-3/8"

1/2"



**2' Offset**  
Pattern # S50062



**8" End Set of 2**  
Pattern # S5006E08



**10" End Set of 2**  
Pattern # S5006E10

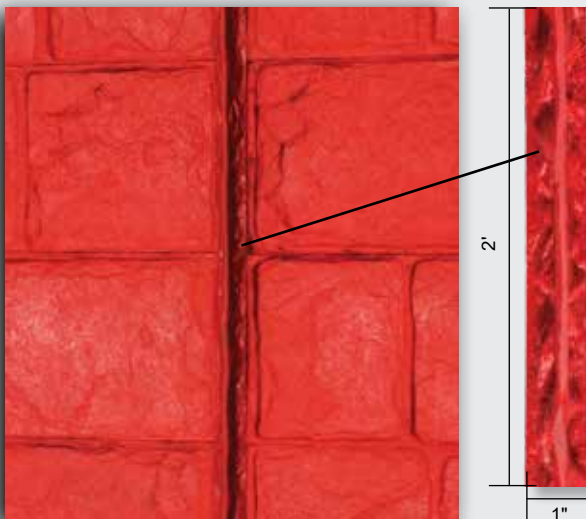

### Control Joint Texture Strip

Pattern # S58001

Refer to ACI Standards and Guidelines on placement of vertical control joint strips

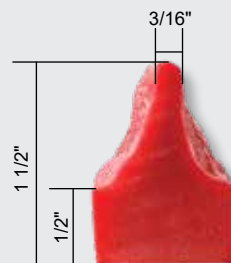

The Control Joint Texture Strip is used to help control random cracking in the wall while adding a decorative feature.



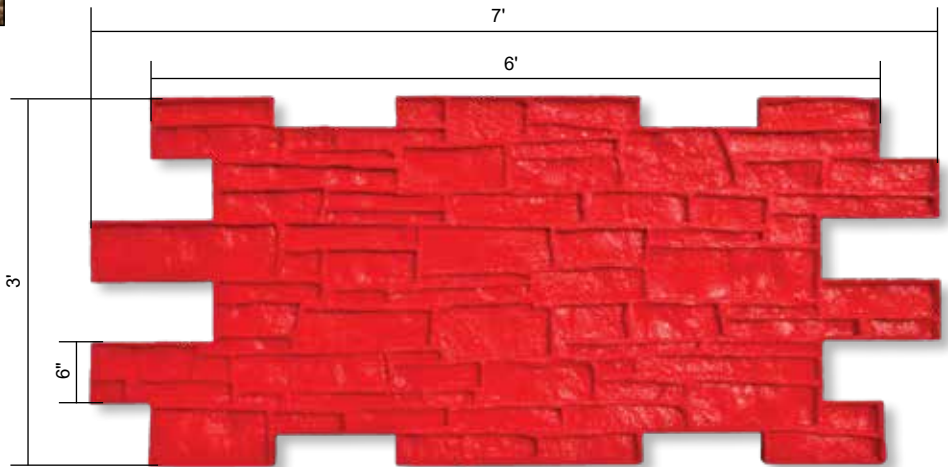
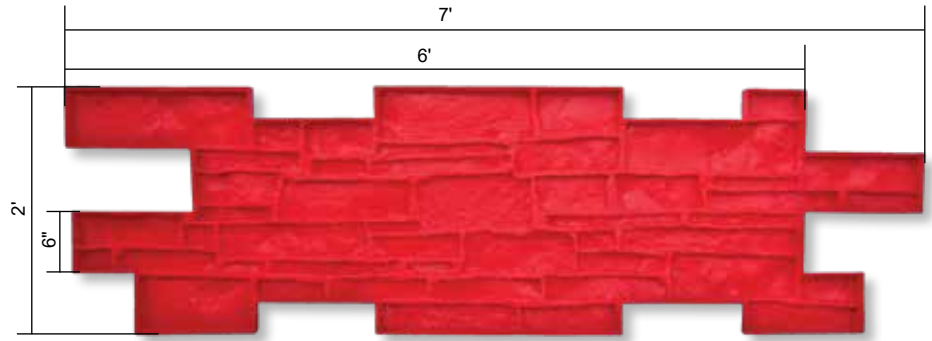

## Country Ledge Form Liner

Patent No. 5,885,502

### Available Tools:

2' – S3624

3' – S3636

6" x 6" Filler Stone – S3606

3" x 12" Filler Stone – S36123

6" x 12" Filler Stone Single – S36126SINGLE

6" x 12" Filler Stone Double – S36126DOUBLE

**Grout Line Width: 1/2"-1"**

### Additional Tools:

Extension – (see pattern #(s) below)

Outside Corner A – (see pattern #(s) below)

Outside Corner B – (see pattern #(s) below)

Inside Corner D – (see pattern #(s) below)

Inside Corner E – (see pattern #(s) below)

10" End Piece C – (see pattern #(s) below)

12" End Piece C – (see pattern #(s) below)

The 2' and 3' liners can be used together to create any wall height in one foot increments

### 6" x 6" Filler Stone

Pattern # S3606



All corners and end pieces are labeled on the back for identification



### 10" End Piece C

Available Sizes:

2' – S3624C

3' – S3636C



### 3" x 12" Filler Stone

Pattern # S36123



### 6" x 12" Filler Stone – Single

Pattern # S36126S



### 6" x 12" Filler Stone – Double

Pattern # S36126D



### 12" End Piece C

Available Sizes:

2' – S3624C 12



### Extension

Available Sizes:

2' – S3624X

3' – S3636X



### Outside Corner (2 pieces)

Available Sizes:

2' A – S3624A

2' B – S3624B

3' A – S3636A

3' B – S3636B



### Inside Corner (2 pieces)

Available Sizes:

2' D – S3624D

2' E – S3624E

3' D – S3636D

3' E – S3636E





# COUNTRY LEDGE FORM LINER



## Country Ledge Column Form

- Can be used to create stand alone columns or in conjunction with the Country Ledge Form Liner System
- Natural look of real stone
- Extender pieces are used to increase the height of both size columns by 6"

### Available Tools:

- 24" A – S361824A (see **A**)
- 24" B – S361824B (see **B**)
- 24" C – S361824C (see **C**)
- 24" D – S361824D (see **D**)
- 40" A – S361840A
- 40" B – S361840B
- 40" C – S361840C
- 40" D – S361840D

### Additional Tools:

- 6" Extender A – S361806A
- 6" Extender B – S361806B
- 6" Extender C – S361806C
- 6" Extender D – S361806D



Grout Line Width: 1/2"-1"

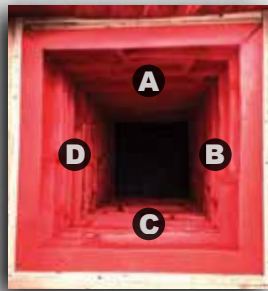

All liner pieces are labeled on the back for identification

Also available in 40" height

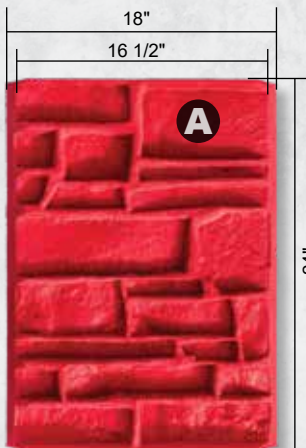

**6" Extender A**  
Pattern # S361806A



**6" Extender B**  
Pattern # S361806B



**6" Extender C**  
Pattern # S361806C

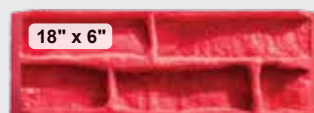

**6" Extender D**  
Pattern # S361806D







2 1/2" Cantilevered Cut Stone Step Liner and Riser Stone Liner

## Stone Form Liners

### 2 1/2" Cantilevered Cut Stone Step Liner

Pattern # S9101

**Additional Tools:**

90° Outside Corner – S9103 (see **E**)

90° Inside Corner – BST9109 (see **F**)

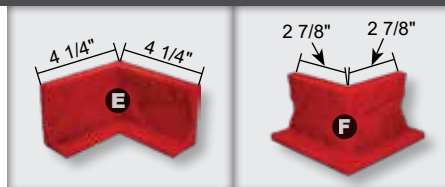

2 1/2" Cantilevered Cut Stone Step Liner

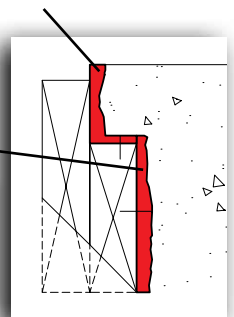

### 4" Cantilevered Cut Stone Step Liner

Pattern # S9102

**Additional Tools:**

90° Outside Corner – S9105 (see **G**)

90° Inside Corner – S9113 (see **H**)

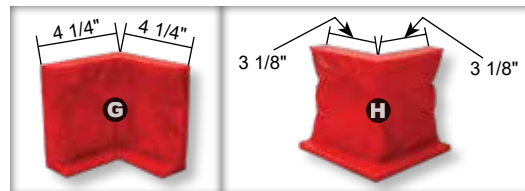



# FORM & STEP LINERS - STONE FORM LINERS



## One Piece Cantilevered Step Liners

**Available Sizes:**  
 8' x 6 1/4" – S9133  
 8' x 7 1/4" – S9150

**Additional Tools:**  
 Corner – S9151

Corner works with both size liners

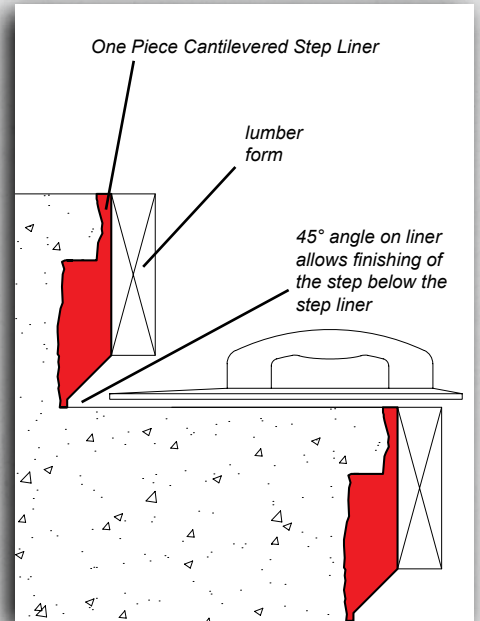

2 1/4"  
 1 3/4"

8' x 6 1/4"



2 1/4"  
 1 3/4"

8' x 7 1/4"

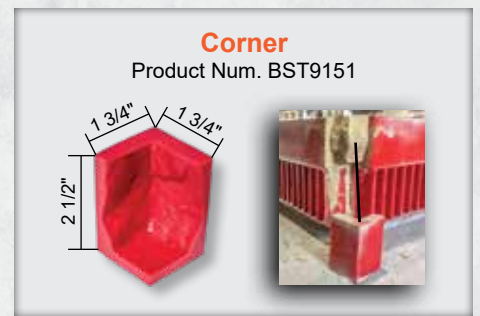

## 45° Stone Edge Step Liners

**Available Sizes:**  
 8' x 6 1/4" – S9135  
 8' x 7 1/4" – S9115

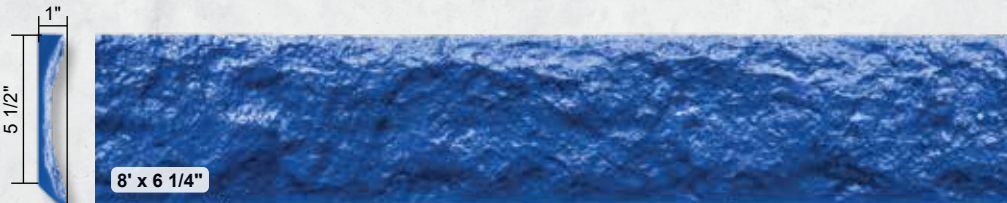

1"  
 5 1/2"

8' x 6 1/4"



1"  
 6 1/2"

8' x 7 1/4"

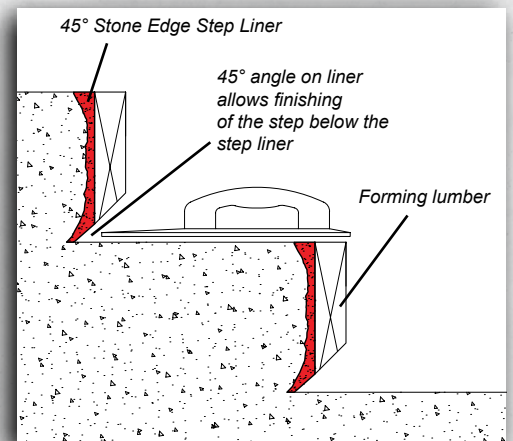





## 1 1/2" Cut Stone Form Liner

Pattern # S9101.5

### Additional Tools:

90° Outside Corner – S9118 (see **A**)

90° Inside Corner – S9119 (see **B**)

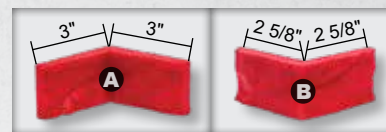

3/8"

8' x 1 1/2"



## 2 1/4" Cut Stone Form Liner

Pattern # S9100

### Additional Tools:

90° Outside Corner – S9107 (see **C**)

90° Inside Corner – S9108 (see **D**)

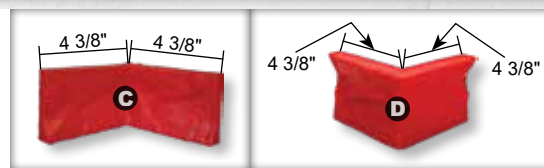

5/8"

8' x 2 1/4"



## 4" Cut Stone Form Liner

Pattern # S9104

### Additional Tools:

90° Outside Corner – S9106 (see **E**)

90° Inside Corner – S9112 (see **F**)

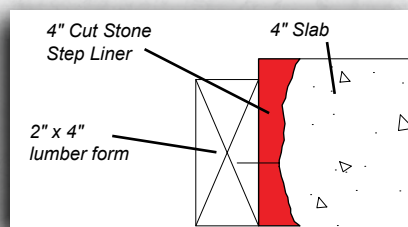
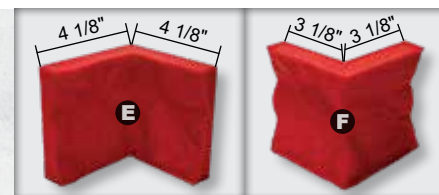

1"

8' x 4"

## 6" Cut Stone Form Liner

Pattern # S9130

### Additional Tools:

90° Outside Corner – S9132 (see **G**)

90° Inside Corner – S9131 (see **H**)

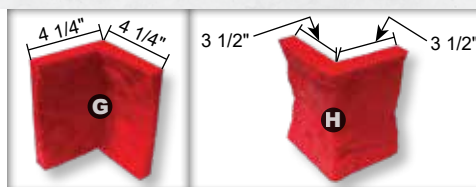

6" Cut Stone Step Liner  
2" x 6" lumber form  
6" Slab

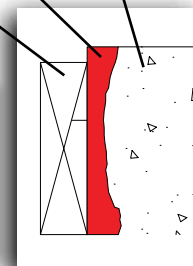

1"

8' x 6"



# FORM & STEP LINERS - STONE FORM LINERS



## 2 1/4" Arcadian Stone Form Liner

Pattern # S9162

### Additional Tools:

90° Outside Corner – S9163 (see **A**)

90° Inside Corner – S9161 (see **B**)

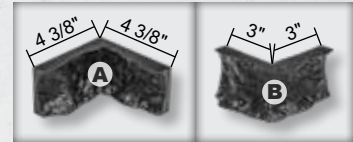

## 4" Arcadian Stone Form Liner

Pattern # S9164

### Additional Tools:

90° Outside Corner – S9165 (see **C**)

90° Inside Corner – S9166 (see **D**)

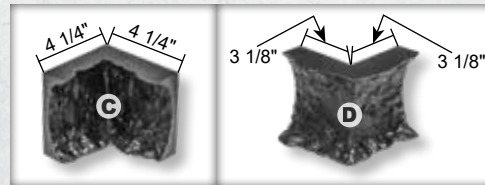

# Bull Nose Form Liners

## 2 1/8" Bull Nose Form Liner

Pattern # S9120

### Additional Tools:

90° Outside Corner – S9121 (see **E**)

90° Inside Corner – S9123 (see **F**)

90° Sweeping Outside Corner – S9122 (see **G**)

90° Sweeping Inside Corner – S9124 (see **H**)

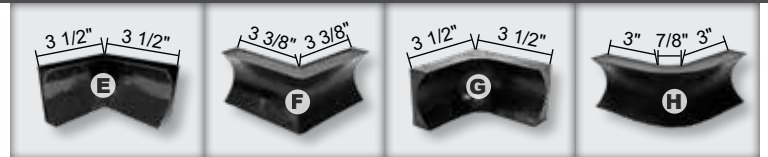

## 2 1/2" Bull Nose with Quarter Round Form Liner

Pattern # S9125







Gilpin's Falls Bridge Plank Texture

## Wood One Piece 7 1/4" Step Liner

Pattern # S9178

- Achieve a cantilevered wood grain edge and wood textured riser without complex forming
- Liner designed to allow for finishing of step or slab below
- Flexible high quality, multiple use urethane liner can be used on radius application
- Specially designed corner piece available for creating cantilevered returns
- Recommended for use with Gilpin's Falls Bridge Plank Texture

### Additional Tools:

Corner – S9179

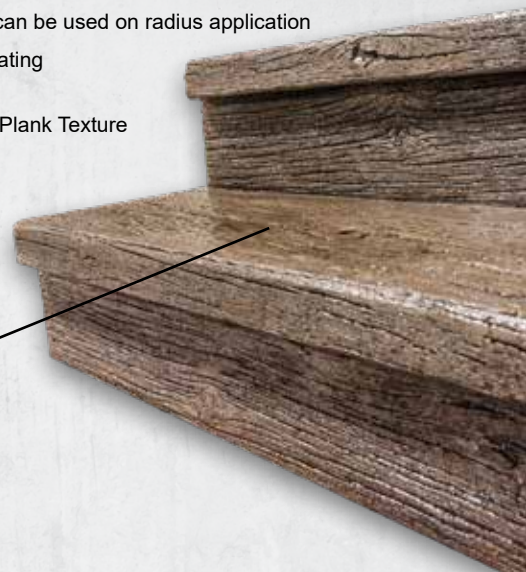
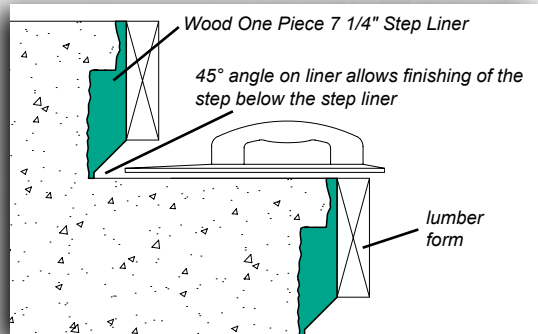

Gilpin's Falls Bridge Plank Texture



**Corner**  
Pattern # S9179



## 4" Gilpin's Falls End Grain Liner

Pattern # S9177

Used to create an end grain texture/pattern on the face of a slab or riser when using Gilpin's Falls Bridge Plank stamp pattern (see page 14)

Image shows cross section only to show texture

**Grout Line Width: 1/8"**  
**Grout Line Depth: 3/16"**



2" Gilpin's Plank Edge Liner

## Gilpin's Plank Edge Liners

Available Sizes:

8' x 2" – S9192

8' x 4" – S9194







4" Light Bark Edge Liner



## Light Bark Edge Liners

Available Sizes:  
 8' x 2" – S9174  
 8' x 4" – S9182  
 8' x 6" – S9170

2" Light Bark Edge Liner

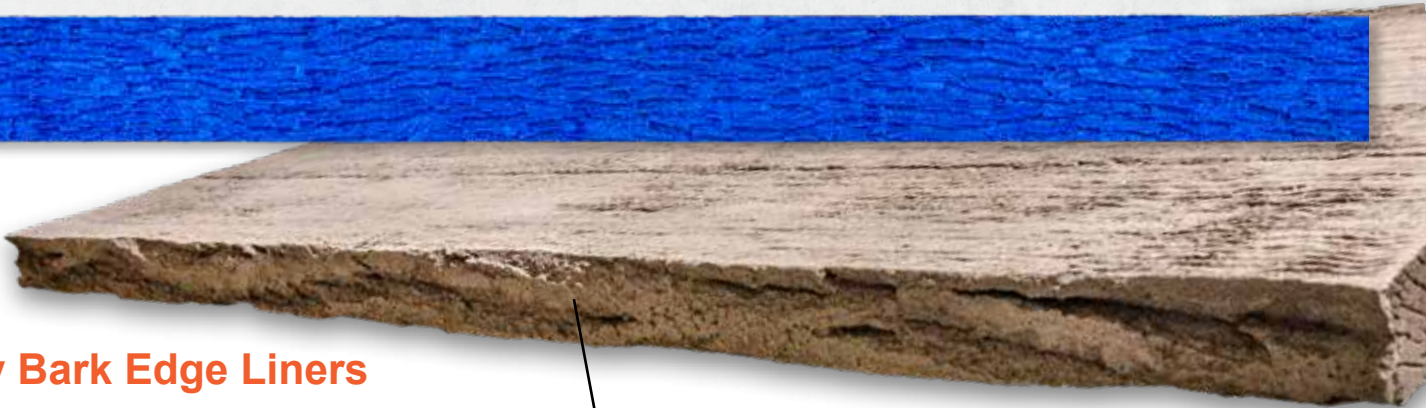

## Heavy Bark Edge Liners

Available Sizes:  
 8' x 2" – S9176  
 8' x 6" – S9172

2" Heavy Bark Edge Liner



## 2 3/8" Bare Tree Edge Liner

Pattern # S9180







## 5 1/8" Riser Cobblestone Liner

Pattern # S9116

Grout Line Width: 1/4"-3/8"

Image shows cross section only to show texture



The 5 1/8" Riser Cobblestone Liner is designed to be used with the 2 1/2" Cantilevered Cut Stone Step Liner and 2 1/4" Cut Stone Step Liner to create 7 3/8" steps or with the 2 1/8" Bull Nose Form Liner to create 7 1/4" steps. It may also be used as a standalone liner.

## 5 1/8" Riser Slate Liner

Pattern # S9117



Grout Line Width: 1/4"

Image shows cross section only to show texture



The 5 1/8" Riser Slate Liner is designed to be used with the 2 1/2" Cantilevered Cut Stone Step Liner and 2 1/4" Cut Stone Step Liner to create 7 3/8" steps or with the 2 1/8" Bull Nose Form Liner to create 7 1/4" steps. It may also be used as a standalone liner.

## 9 1/4" Riser Stone Liner

Pattern # S9110



1/4"

The 9 1/4" Riser Stone Liner can be trimmed on-site to desired riser height. It can be used as a standalone liner or in conjunction with all sizes of the Cut Stone Form Liner, Cantilevered Cut Stone Step Liner, and Bull Nose Form Liner.

## 18" Riser Stone Liner

Pattern # S9111



1/4"

The 18" Riser Stone Liner can be trimmed on-site to desired riser height. It can be used as a standalone liner or in conjunction with all sizes of the Cut Stone Form Liner, Cantilevered Cut Stone Step Liner, and Bull Nose Form Liner.



## 1 1/2" Pebblestone Form Liner

Pattern # S9141



## 7 1/4" Pebblestone Form Liner

Pattern # S9140

