

## TECHNICAL BULLETIN

# Reinforcing Bar Installation in Epoxy Grouts

The use of reinforcement bars is recommended in deep pours to minimize cracking and help transfer stress if cracks do occur. Steel reinforcement or "rebar" is recommended where the total thickness of the grout is greater than 6" (152 mm). No. 4 rebar, 1/2" (13 mm) in diameter, is the minimum size recommended for use with epoxy grout. All rust, dirt and grease should be removed. Sandblasting will provide best adhesion.

A typical rebar layout is shown in Figure 1. Most rebar should run lengthwise in the grout with cross bars and vertical dowels placed at approximately 12–24" (305–610 mm) intervals as shown in Figure 1. Rows of rebar should be between 6–12" (152–305 mm) apart. Grout pours of 6" (152 mm) require only one layer of horizontal rebar. Pours of 10" (254 mm) or more can benefit from an extra layer as shown in Figure 2. The horizontal rebar should be wired to vertical dowels that are grouted into the concrete base as shown in Figure 2. The horizontal and vertical bars are recommended to be constructed of 1/2" (13 mm) rebar and should be embedded to a depth of at least 6" (152 mm) in the concrete.

If the holes in the concrete are at least 1-1/2" (38 mm) in diameter, the bars can be grouted in place using standard machinery grout. If it is desirable to use smaller holes (e.g., about 1" [25 mm] in diameter), the bars should be grouted with a specially formulated rebar grout. None of the rebar should be closer than 2" (51 mm) to the nearest grout surface (Figure 3)

FIGURE 1

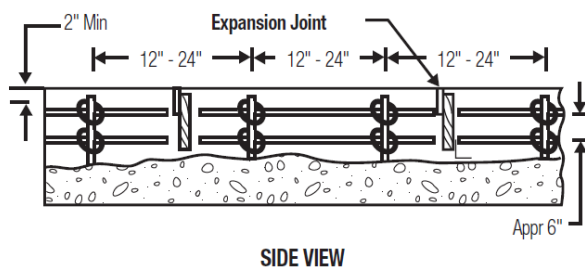

FIGURE 2

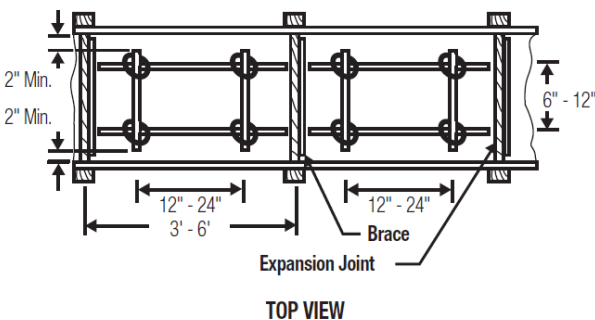
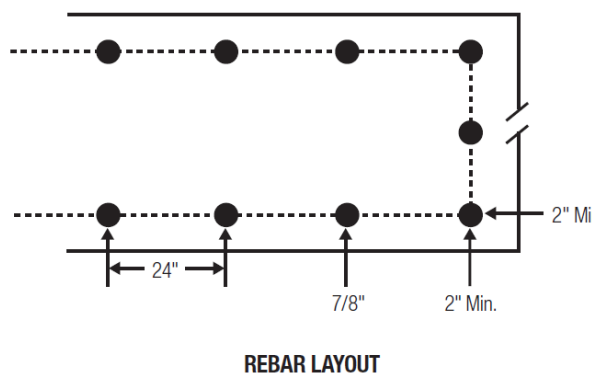

FIGURE 3



---

## HEALTH , SAFETY AND ENVIRONMENTAL

Read, understand and follow all Safety Data Sheets and product label information for this product prior to use. The SDS can be obtained by visiting [usa.sika.com](http://usa.sika.com), e-mailing your request to technical service or calling 1(800)433-9517. Use only as directed. **IN**

**CASE OF EMERGENCY: Call CHEMTEL +1 (800) 255-3924 or if outside the US or Canada, +1 (813) 248-0585.**

---

## LIMITED WARRANTY NOTICE

Sika Corporation warrants this product to be free from manufacturing defects and to meet the technical properties on the current Technical Data Guide, if used as directed within shelf life. Satisfactory results depend not only on quality products but also upon many factors beyond our control. SIKI MAKES NO OTHER WARRANTY OR GUARANTEE, EXPRESS OR IMPLIED, INCLUDING WARRANTIES OF MERCHANTABILITY OR FITNESS FOR A PARTICULAR PURPOSE WITH RESPECT TO ITS PRODUCTS. The sole and exclusive remedy of Purchaser for any claim concerning this product, including but not limited to, claims alleging breach of warranty, negligence, strict liability or otherwise, is shipment to purchaser of product equal to the amount of product that fails to meet this warranty or refund of the original purchase price of product that fails to meet this warranty, at the sole option of Sika. Any claims concerning this product must be received in writing within one (1) year from the date of shipment and any claims not presented within that period are waived by Purchaser. SIKI WILL NOT BE RESPONSIBLE FOR ANY SPECIAL, INCIDENTAL, CONSEQUENTIAL (INCLUDING LOST PROFITS) OR PUNITIVE DAMAGES OF ANY KIND.

Purchaser must determine the suitability of the products for the intended use and assumes all risks and liabilities in connection therewith. This information and all further technical advice are based on Sika's present knowledge and experience. However, Sika assumes no liability for providing such information and advice including the extent to which such information and advice may relate to existing third party intellectual property rights, especially patent rights, nor shall any legal relationship be created by or arise from the provision of such information and advice. Sika reserves the right to make any changes according to technological progress or further developments. The Purchaser of the Product(s) must test the product(s) for suitability for the intended application and purpose before proceeding with a full application of the product(s). Performance of the product described herein should be verified by testing and carried out by qualified experts.

**Sika Corporation**  
201 Polito Ave  
Lyndhurst, NJ 07071  
Phone: +1 800-933-7452  
Fax +1 201-933-6225  
[usa.sika.com](http://usa.sika.com)

**BUILDING TRUST**

