



# SIKATACK® PANEL SYSTEM

## INTERIOR AND EXTERIOR WALL CLADDING

SikaTack® Panel System is an architectural system designed for both new buildings and refurbishments. This system enables the façade to be a defining element of a well-designed building.



### PRODUCT BENEFITS

- Aesthetically pleasing – no screws or rivets
- Elastic bonding provides uniform tension over the whole panel, therefore no deflection of panels
- Extremely cost effective due to fast and economical installation
- Increased thermal performance on exterior walls
- One mounting system for most type of panels

### THE SYSTEM INCLUDES

- SikaTack® Panel-50
- SikaTack® Panel Primer
- SikaTack® Panel Tape
- Sika® Aktivator-205

# APPLICATION STEPS

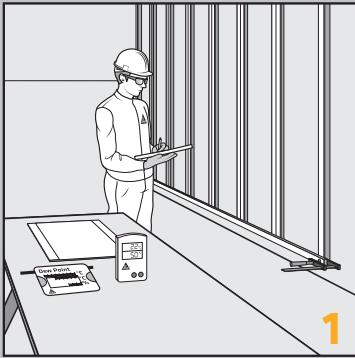

1  
A well prepared working place is important for working with adhesives. Mark precisely where the first panel must be bonded on the substructure, or use a reference fixed on the substructure. Make notes for your record with all relevant informations.

Ambient Temperature 40 - 95°F  
(5 - 35°C).

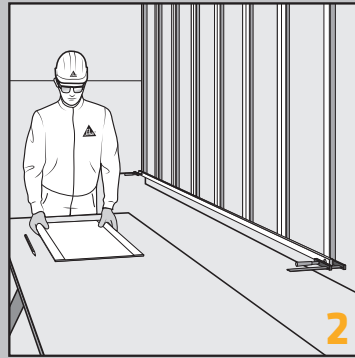

2  
The surface to be bonded must be clean, dry and free from dirt. Abrading with an abrasive pad (80 grit) on the panel and the substructure when recommended for the specific system.

Ask Sika representative or the panel supplier for specific advice on pre-treatment steps.



3  
Remove dust with a lint-free paper towel.



4  
Activate the bond faces with Sika® Aktivator-205. Use a clean, lint-free paper towel and wipe in one direction only (dirty cloths must be replaced).

Allow a flash off time of 10 minutes.



5  
Shake SikaTack® Panel Primer thoroughly (the movement of the steel balls in the container must be clearly audible). Apply one thin coat of SikaTack® Panel Primer uniformly over the whole surface with a felt pad.

Allow a flash off time of at least 30 minutes.



6  
Apply SikaTack® Panel Tape over the whole length of the vertical sections and parallel to the edges.

Do not pull off the protective foil at this time.



7  
Apply SikaTack® Panel-50 in a triangular bead by using a triangular nozzle (width 8 mm, height 10 mm) with at least 5 mm gap to the fixing tape and to the side of the batten.



8  
Remove the protective foil on the SikaTack® Panel Tape.



9  
Place the cladding panel in the required position first, without the panel touching the fixing tape. Then, press it firmly until it touches the SikaTack® Panel Tape.

## SYSTEM COMPONENTS

- A. **SikaTack® Panel-50** One-part moisture curing and structural adhesive
- B. **SikaTack® Panel Tape** Closed-cell PE foam core with pressure-sensitive adhesive for panel prefixation
- C. **SikaTack® Primer** Pigmented, solvent-based adhesion promoter
- D. **Aluminium Rail System**
- E. **Facade Panel**
- F. **Insulation Material** (e.g. mineral wool)

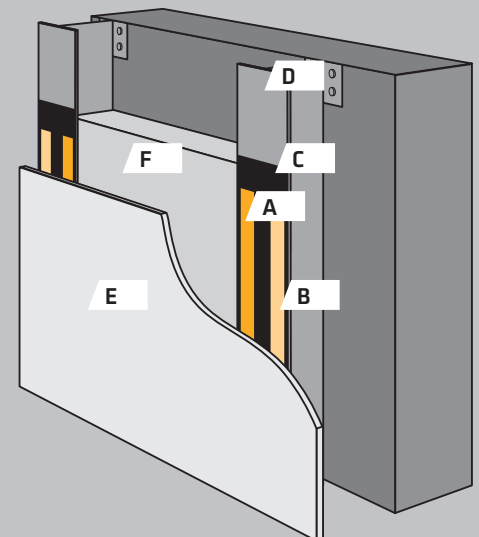

NOTE: For full application instructions, please refer to the latest Product Data Sheet and the General Guideline for SikaTack® Panel System.