

QUICK CLIP

INSULATION ATTACHMENT SYSTEM

PRODUCT DESCRIPTION

The Quick Clip insulation retaining system is ideal for holding insulation securely on tilt-up walls. Its quick and easy installation method helps reduce your overall costs. Suitable for use in metal buildings, wood framed and concrete construction.

FEATURE AND BENEFITS

- **Easy Handling** – can be cut with standard power saws and two piece design allows for easy installation of the insulation
- **Durable** – PVC is durable and will maintain its attractive finish for years
- **Impact-Resistant PVC** – designed to withstand the impact of a nail gun without splitting
- **Easy to Work With** - can be cut with standard power saws
- **UL Tested** – Class A material, tested by Underwriters Laboratories (UL 723 – test for surface burning characteristics of building materials). Flame spread is 0 and smoke developed equals 190.

INSTALLATION

- **Step 1** – Align the Quick Clips at widths appropriate for insulation size.
- **Step 2** – Nail or staple the Quick Clips into place.
- **Step 3** – Slide/fit insulation into clip.



Quick Clip Insulation Attachment System

INSULATION ATTACHMENT SYSTEM

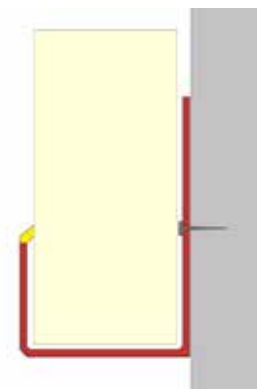
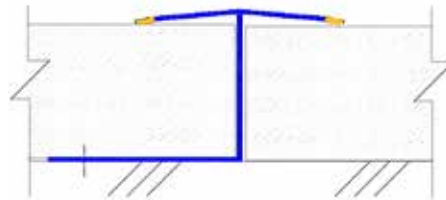
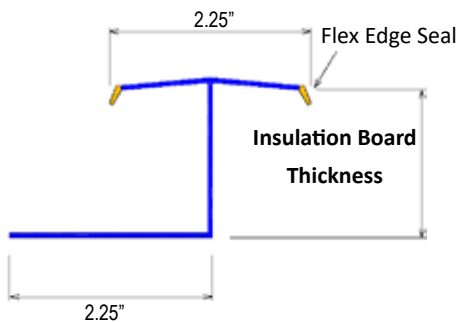

Flex-Tite J-Channel is an ideal way to finish edges when used with the Quick Clip System.

MANUFACTURED BY VICTORY BEAR, A DIVISION OF FUKUVI-USA, INC. / SOLD BY RMAX



BUILDING TRUST



Quick Clip

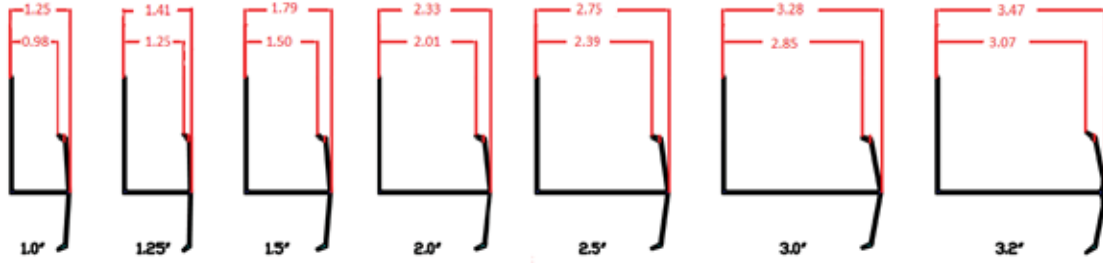

J-Channel

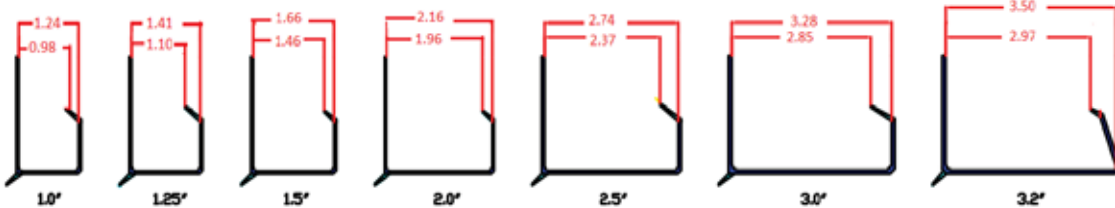

INSULATION BOARD SIZING CHART		
ECOMAXCI® FR WHITE THICKNESS	QUICK CLIP PART #	J-CHANNEL PART #
1.0"	1552	1540
1.25"	861	751
1.5"	1551	769
2.0"	1553	1541
2.5"	1555	1153
3.0"	1554	1547
3.2"	1559	1560

All Insulation Retainers are 10ft./piece, 20 pieces/box.
Storage: material should be stored out of direct sunlight to prevent long-term deterioration or color fading. Pieces can be stacked, but should be stored fully supported to keep them from warping.

PROPERTIES	
Coefficient of Linear Expansion	.0132 inches per degree F

WARNING: Quick Clip Insulation Clips may exhibit gaps due to differences in the tolerance of the insulation clips and that of the insulation.

RMAX SALES OFFICES / PLANT

Central
13524 Welch Road
Dallas, TX 75244
(P) 972-387-4500
(F) 972-387-4673

East
1649 South Batesville Road
Greer, SC 29650
(P) 864-297-1382
(F) 864-234-7548

West
210 Lyon Drive
Fernley, NV 89408
(P) 775-575-4849
(F) 775-575-5035

rmax@rmax.com / www.rmax.com



PRODUCT DATA SHEET
QUICK CLIP INSULATION CLIP
Revision.12-09-2020



BUILDING TRUST

