

DOWEL DETAIL

APPLY SIKAFLEX - 1A AROUND DOWEL. CUT A HOLE IN THE CENTER OF FLASHING PIECE SMALLER THAN DOWEL DIAMETER, STRETCH FLASHING PIECE DOWN DOWEL AND HOT-AIR WELD IN-PLACE.

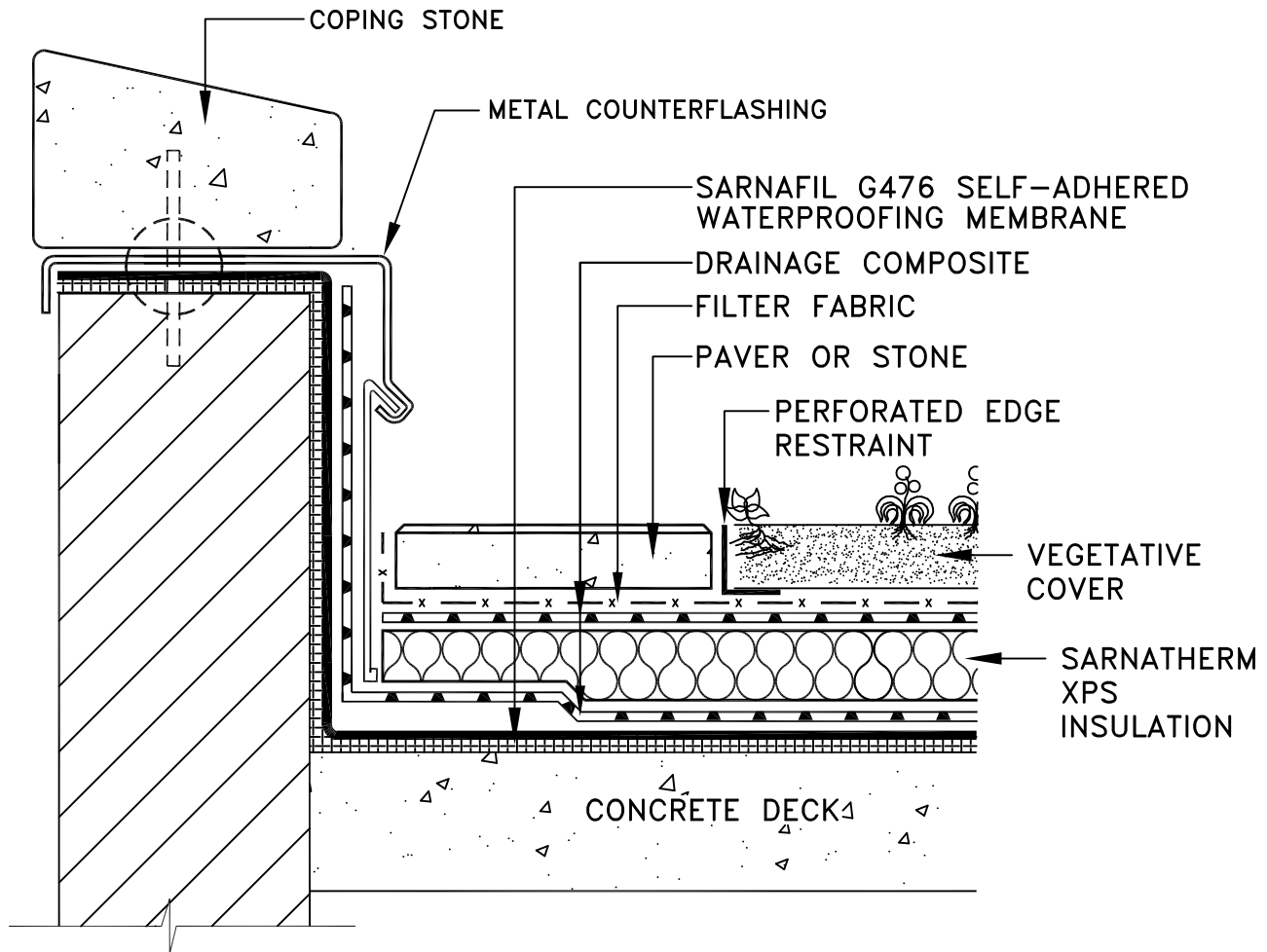

NOTES:

- 1) ALL FLASHING SHALL EXTEND A MIN. OF 8 INCHES ABOVE THE OVERBURDEN.
- 2) METAL COUNTERFLASHING AND COPING STONE ARE TO BE INSTALLED TO MEET LOCAL CODES AND REQUIREMENTS.
- 3) SEALANT IS A MAINTENANCE ITEM NOT COVERED UNDER SIKA SARNAFIL WARRANTY.

COPING STONE

BUILDING TRUST
781-828-5400



JOB NAME:

XXX
XXX

SCALE: N.T.S.

DATE: 5/15

FILE NO.: GRAPMA-2.2

DRW. NO.: XXX

AS A MEMBRANE MANUFACTURER, SIKA CORPORATION ("SIKA") REVIEWS DETAILS PREPARED BY THE CONSULTANT, ARCHITECT AND/OR ENGINEER FOR A PROJECT SOLELY FOR THE PURPOSE OF DETERMINING IF A SIKA WARRANTY MAY ISSUE FOR THE PROJECT. THIS REVIEW IS NOT TO BE CONSTRUED AS APPROVAL OF DETAILS BY SIKA AND IS NOT BEING CONDUCTED IN LIEU OF SOUND ENGINEERING AND ARCHITECTURAL PRACTICES AND JUDGMENT AND SHOULD NOT BE RELIED UPON FOR THAT PURPOSE. SIKA CORPORATION ASSUMES NO LIABILITY WITH RESPECT TO THE DESIGN OF THE ROOFING OR WATERPROOFING SYSTEM. THE ARCHITECT, CONSULTANT AND/OR ENGINEER OR DESIGN PROFESSIONAL FOR A PARTICULAR PROJECT BEARS THE SOLE RESPONSIBILITY FOR THE DESIGN OF THE ROOFING OR WATERPROOFING SYSTEM. FOR THE PREPARATION AND APPROVAL OF THE DETAILS AND SHOP DRAWINGS, AND FOR DETERMINING THEIR SUITABILITY FOR A PARTICULAR PROJECT OR APPLICATION, WHILE SIKA PROVIDES GENERAL INSTRUCTIONS FOR THE INSTALLATION OF ITS MEMBRANE AS WELL AS TRAINING FOR SIKA AUTHORIZED APPLICATORS, THE MEANS AND METHODS USED BY THE CONTRACTOR FOR SURFACE PREPARATION AS WELL AS THE MEANS AND METHODS EMPLOYED BY THE CONTRACTOR IN THE INSTALLATION OF THE SIKA MEMBRANE ARE THE RESPONSIBILITY OF THE CONTRACTOR. ALL SALE OF SIKA PRODUCTS AND SERVICES ARE SUBJECT TO SIKA TERMS AND CONDITIONS OF SALE AVAILABLE AT USA.SARNAFIL.SIKA.COM.